



PEUGEOT

508

Réf. : 9627.PF

Réf. : 9627.PG

Réf. : 9627.PH

FR NOTICE DE POSE A USAGE PROFESSIONNEL / LES PHOTOS ET LES DESSINS NE SONT PAS CONTRACTUELS
 GB FITTING INSTRUCTIONS FOR PROFESSIONAL FITTERS / THE PHOTOGRAPHS AND DRAWINGS ARE NOT CONTRACTUAL
 ES INSTRUCCIONES DE MONTAJE PARA USO PROFESIONAL / LAS FOTOGRAFIAS Y LOS DIBUJOS NO SON CONTRACTUALES
 P MANUAL DE MOTAGEM PARA UTILIZACÃO PROFISSIONAL / AS FOTOGRAFIAS E OS DESENHOS NÃO SÃO CONTRATUAIS
 DE MONTAGEANLEITUNG FÜR PROFESSIONNELLEN EINSATZ / DIE FOTOS UND DIE ZEICHNUNGEN SIND NICHT VERTRAGLICH
 IT ISTRUZIONI DI POSA AD USO PROFESSIONALE / LE FOTOGRAFIE ED I DISEGNI NON SONO CONTRATTUALI
 NL MONTAGEHANDLEIDING VOOR PROFESSIONEEL GBRUIK / DE FOTO'S EN DE TEKENINGEN ZIJN NIET CONTRACTUEEL

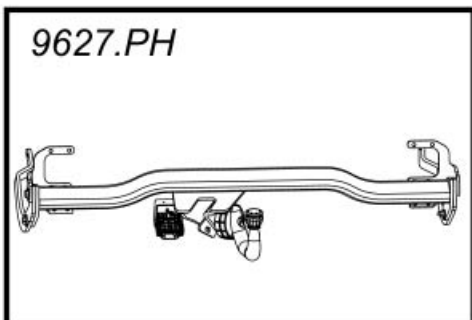
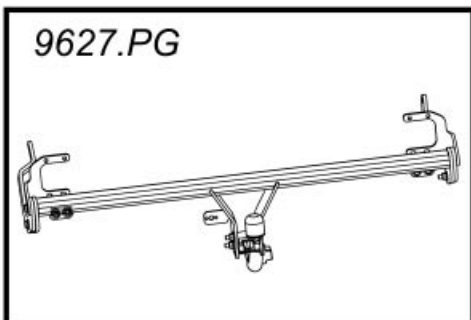
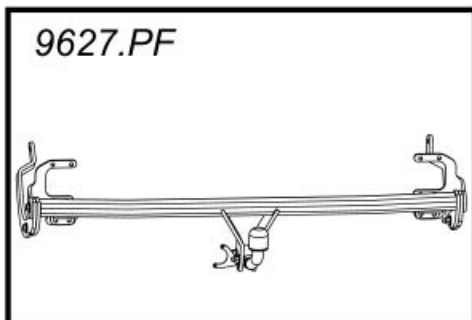
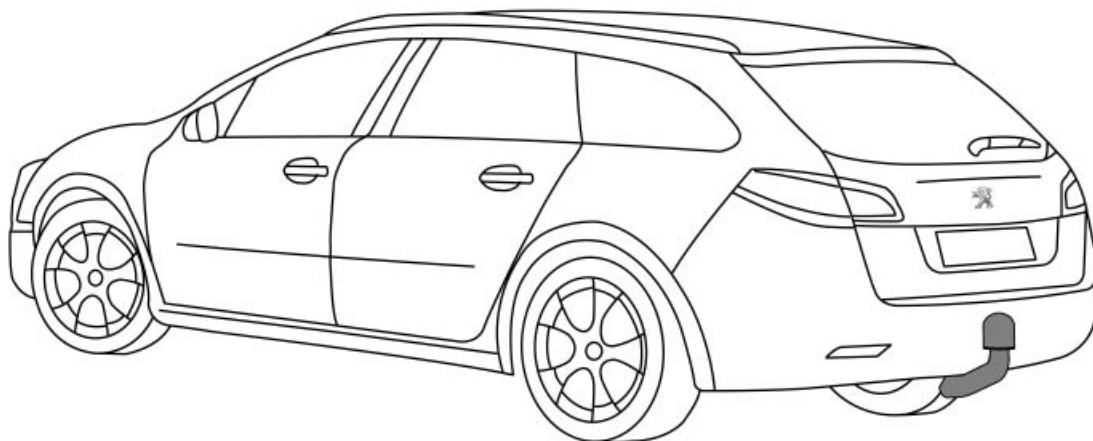

<p>NOK</p> <p>→</p> <p>OK</p>		

9910115629 - REV. 00

Type : 033845	EC 94/20		
D 10,87 kN	 e4 - 00 - 4228		
$\frac{V \times R}{V + R} \times 0,00981 \leq D \text{ (kN)}$			

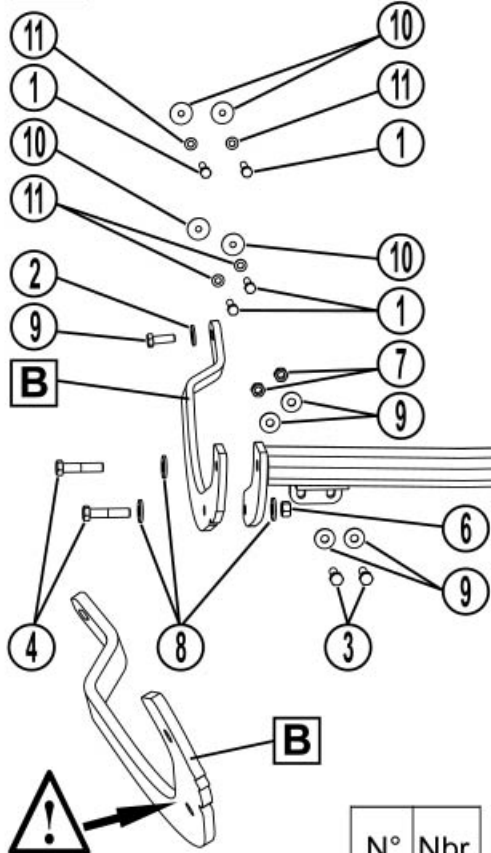
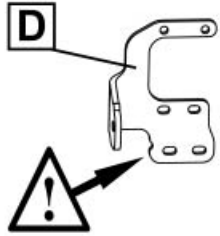

	N°	Nbr.
M8 x35	1	x 8
HM10x30	2	x 2
HM10x35	3	x 4
HM12x55	4	x 4
HM12x70	5	x 2
HM12	6	x 4
HM10	7	x 4

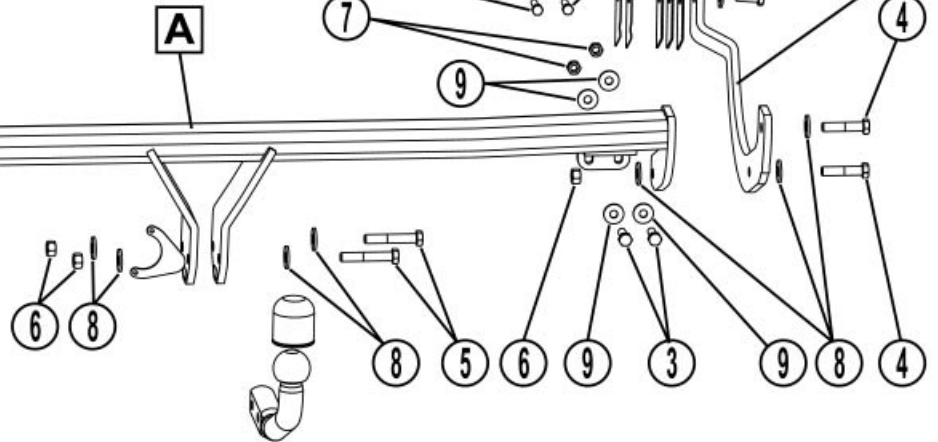

	N°	Nbr.
12 x30x3,2	8	x10
10x27x2,8	9	x10
8x30x1,5	10	x 8
8x16x1,9	11	x 8
1mm	12	x 2
2mm	13	x 3

	N°	Nbr.

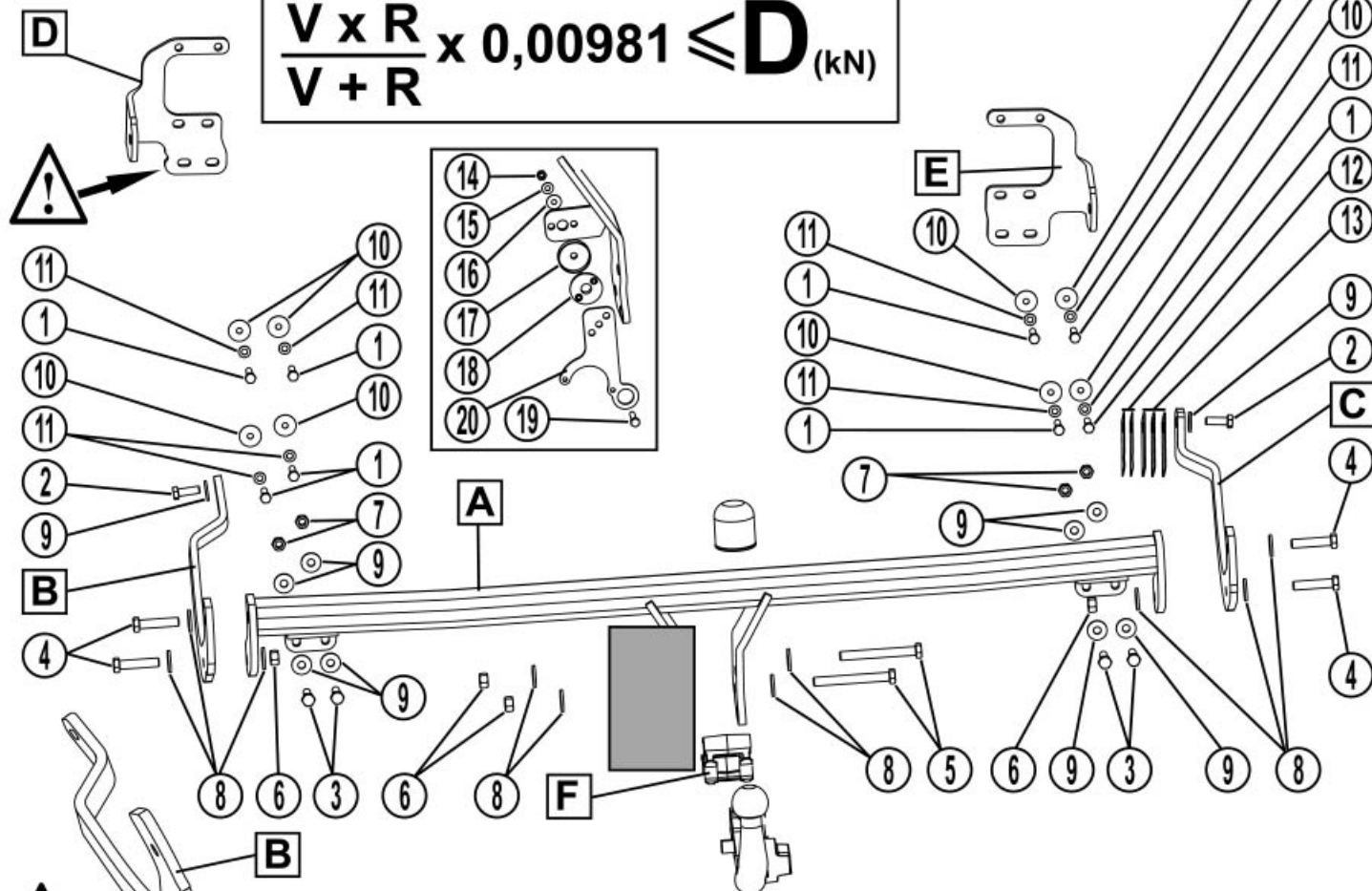
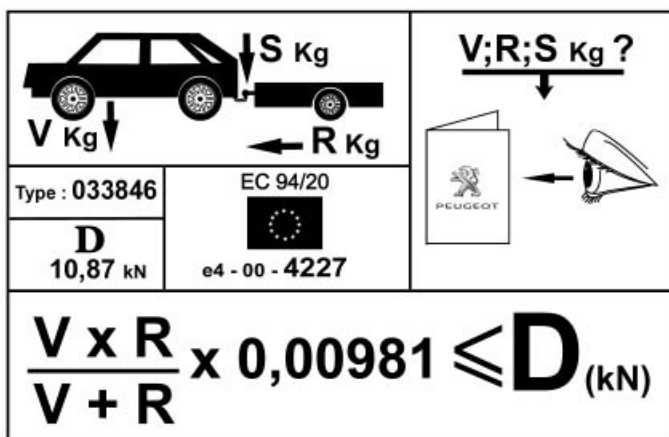

		N°	Nbr.			N°	Nbr.			N°	Nbr.
	M8 x35	1	x 8		12 x30x3,2	8	x10		HM6	14	x 1
	HM10x30	2	x 2		10x27x2,8	9	x10		6x18x1,2	15	x 1
	HM10x35	3	x 4		8x30x1,5	10	x 8		6x18x1,5 (NYLON)	16	x 1
	HM12x55	4	x 4		8x16x1,9	11	x 8			17	x 1
	HM12x105	5	x 2		1mm	12	x 2			18	x 1
	HM12	6	x 4		2mm	13	x 3		HM6x30	19	x 1
	HM10	7	x 4							20	x 1

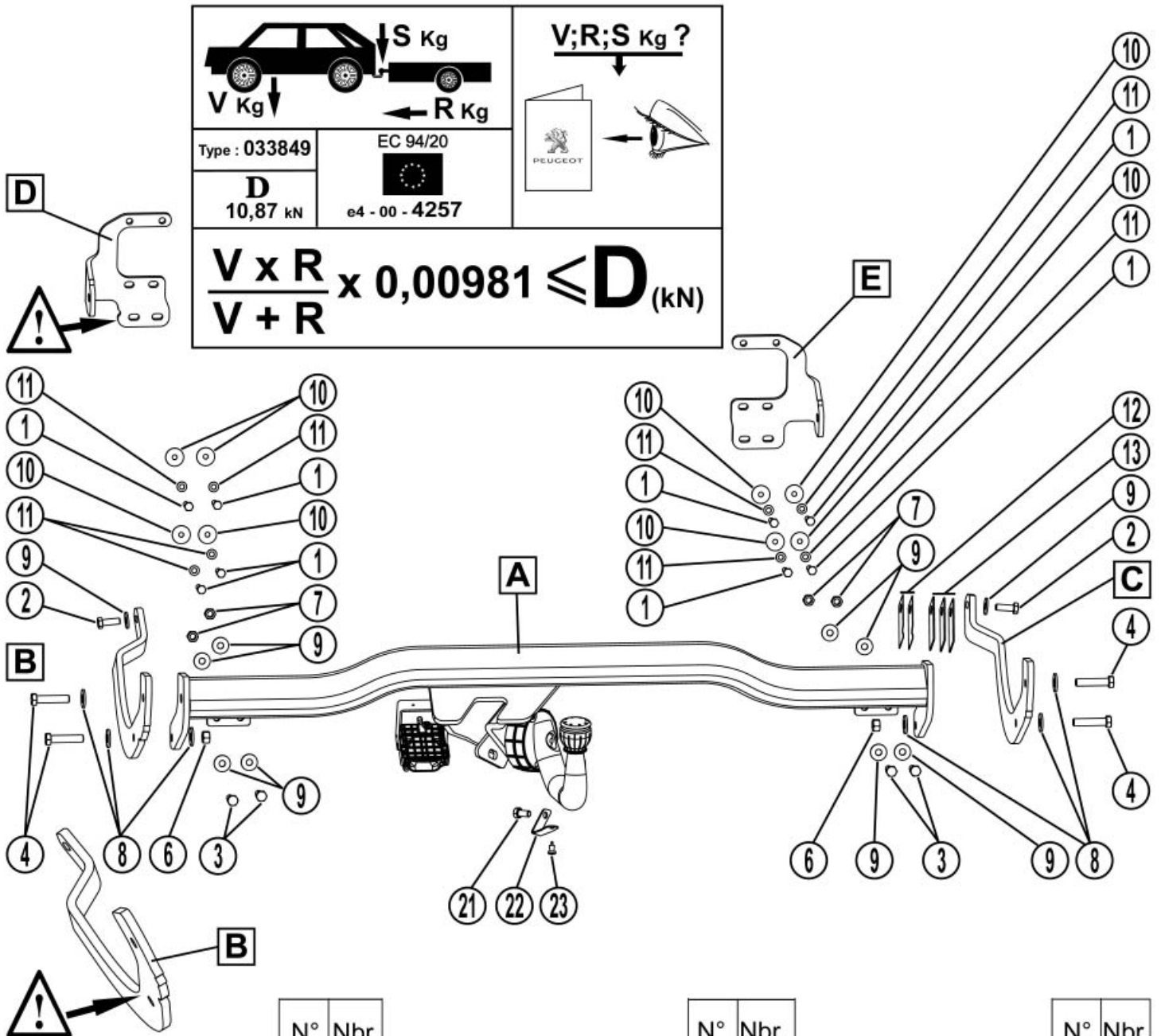

		N°	Nbr.			N°	Nbr.			N°	Nbr.
	M8 x35	1	x 8		12x30x3,2	8	x 6		HM10x20	21	x 1
	HM10x30	2	x 2		10x27x2,8	9	x 10			22	x 1
	HM10x35	3	x 4		8x30x1,5	10	x 8			23	x 1
	HM12x55	4	x 4		8x16x1,9	11	x 8				
					1mm	12	x 2				
	HM12	6	x 2		2mm	13	x 3				
	HM10	7	x 4								

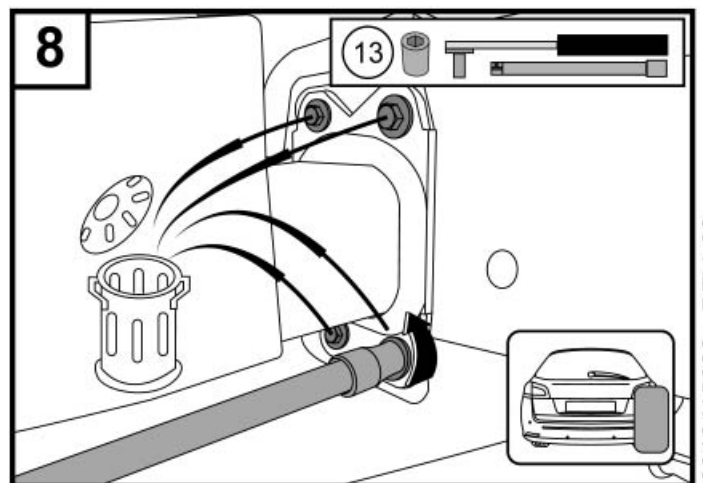
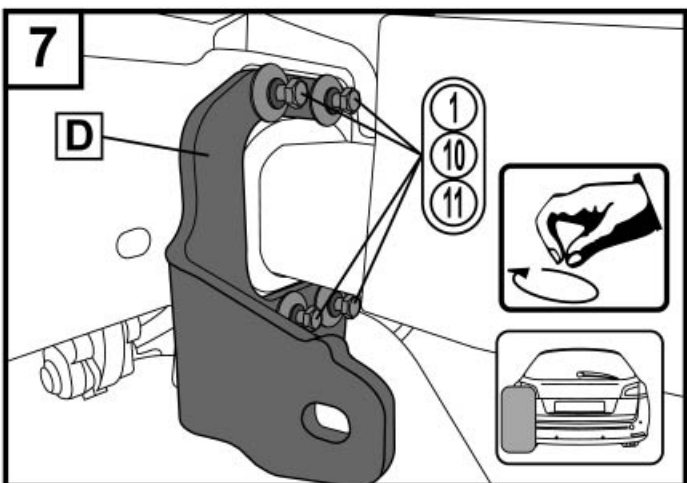
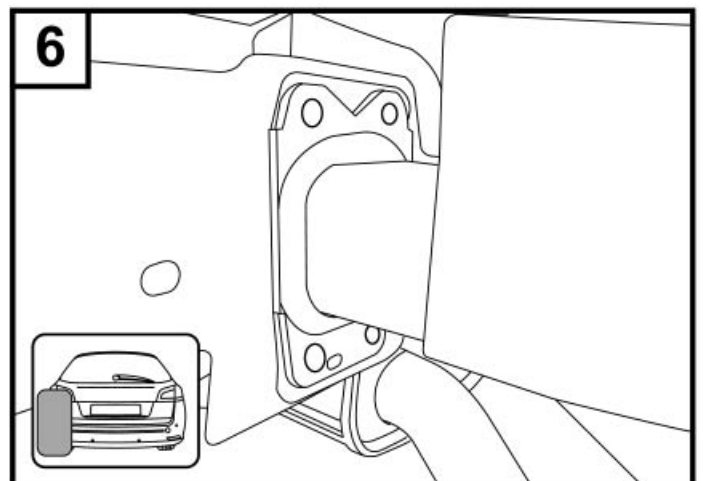
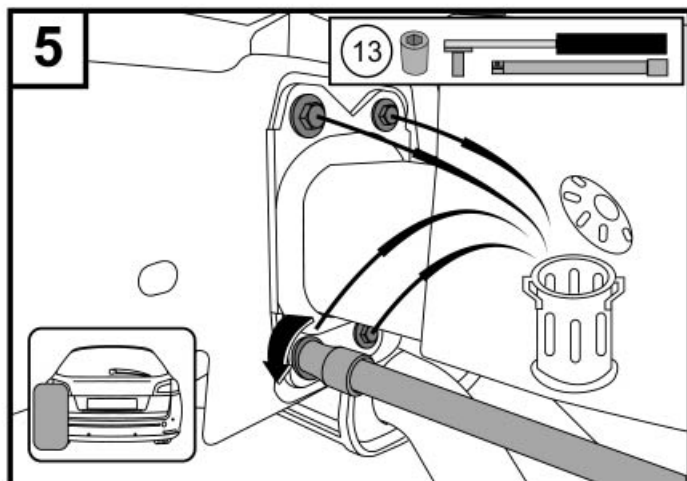
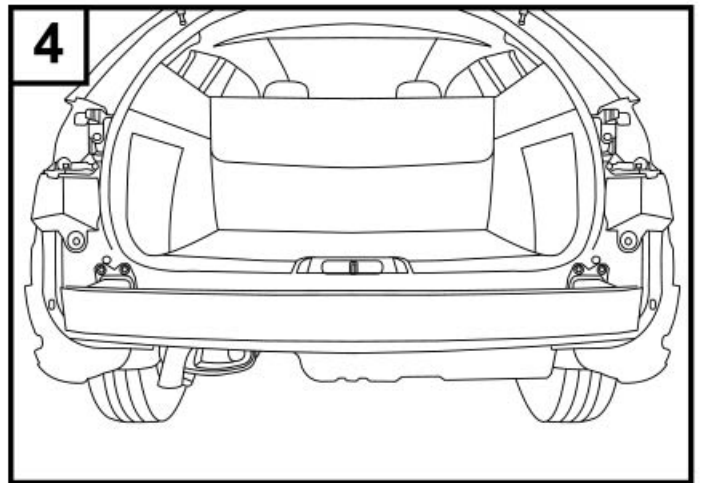
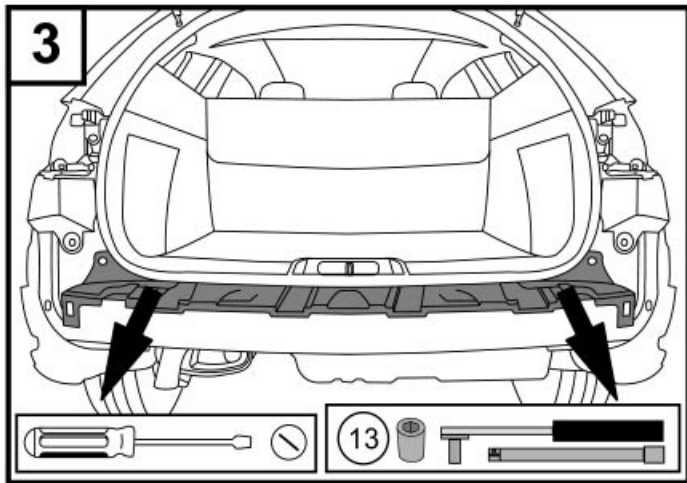
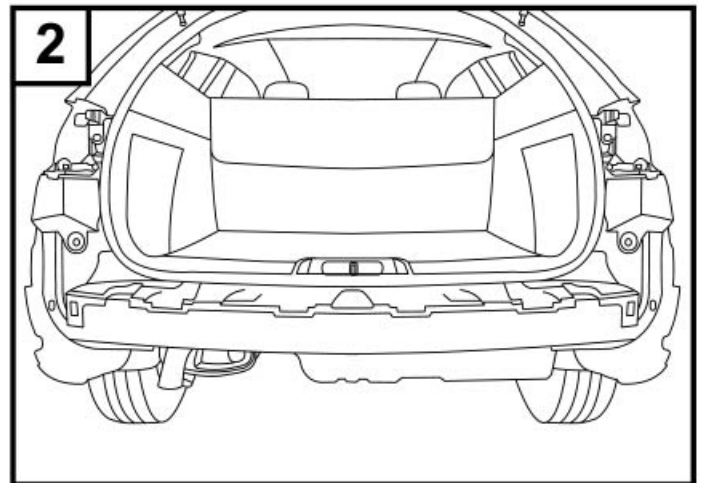
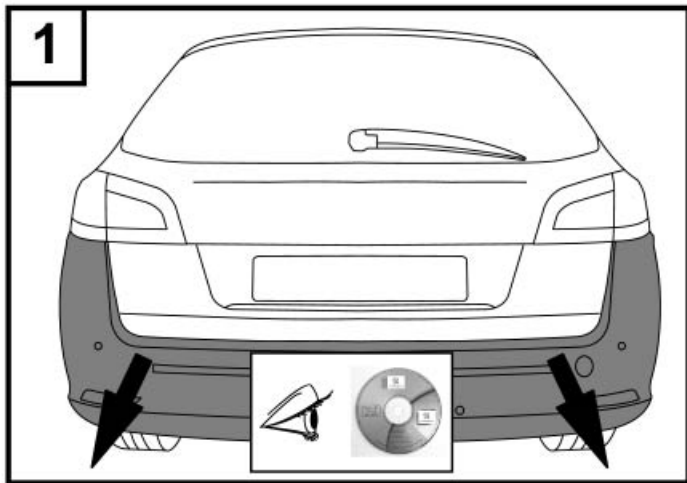

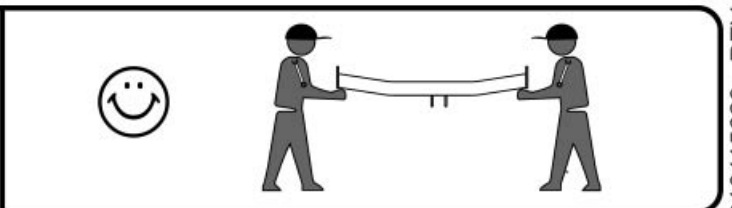
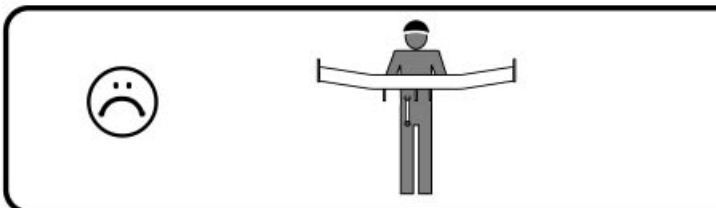
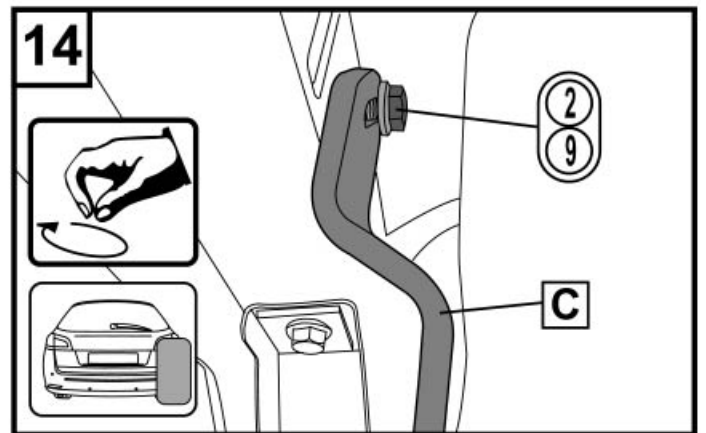
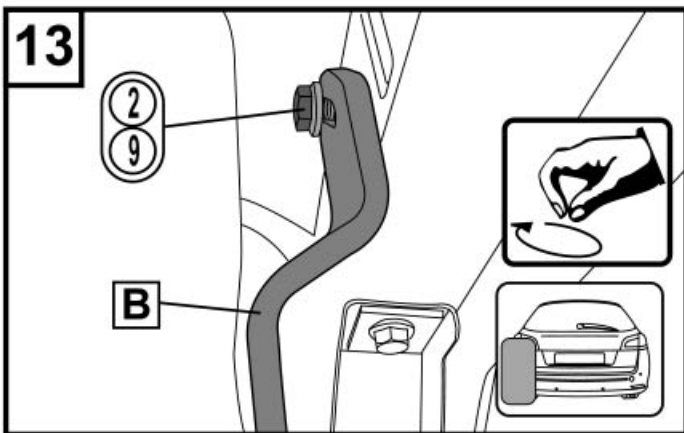
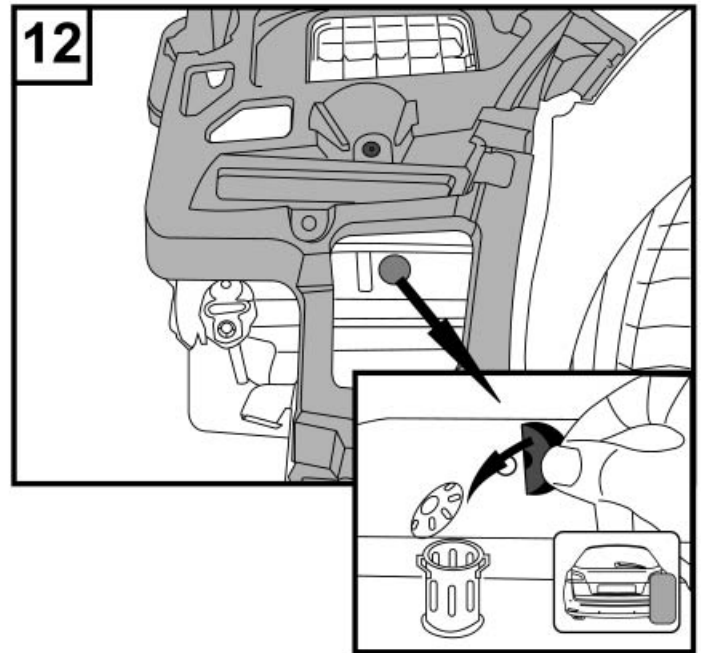
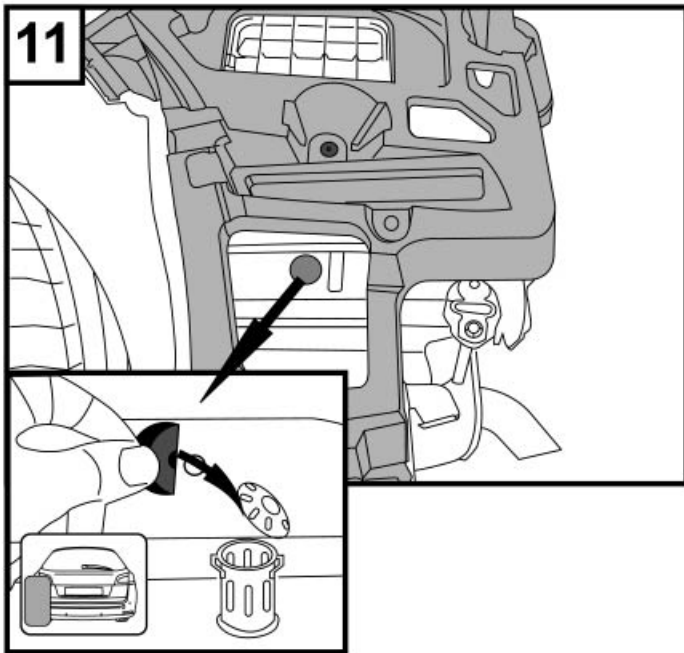
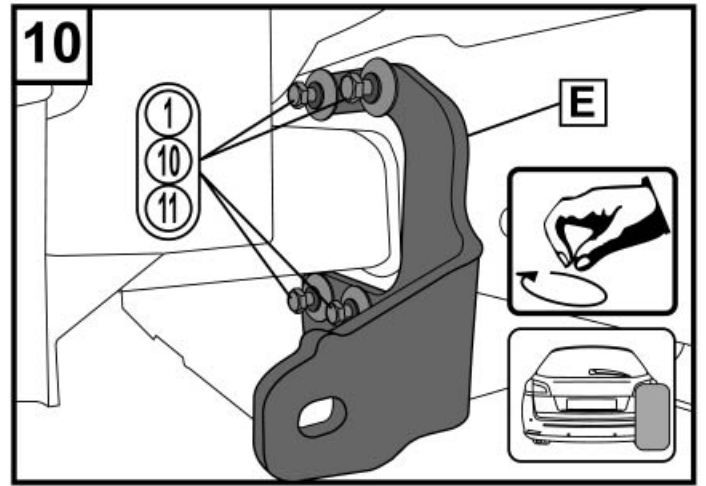
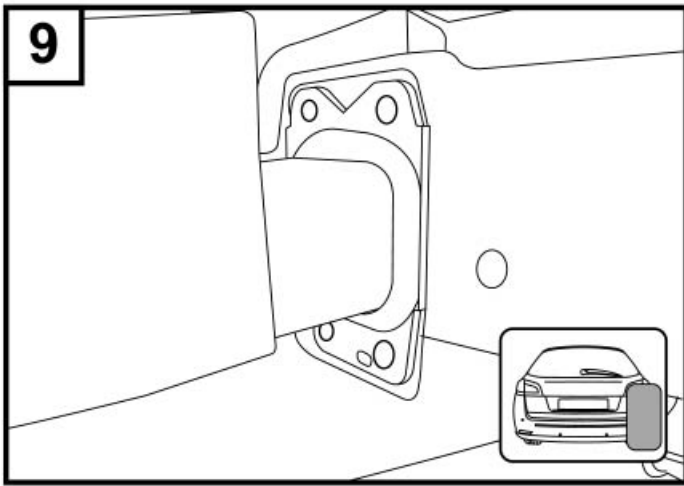

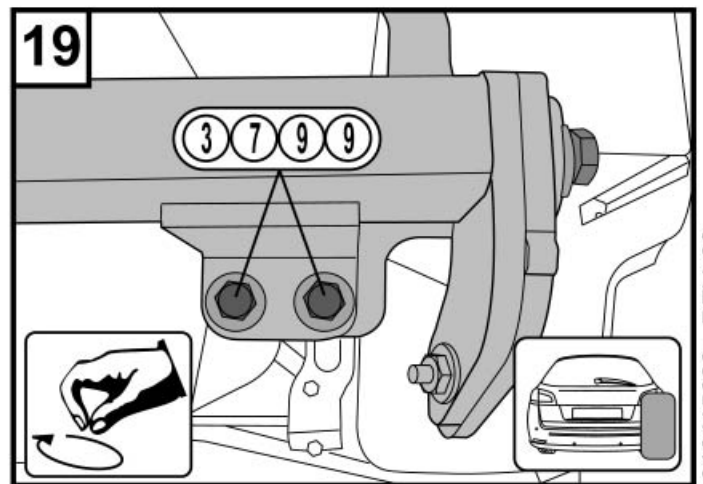
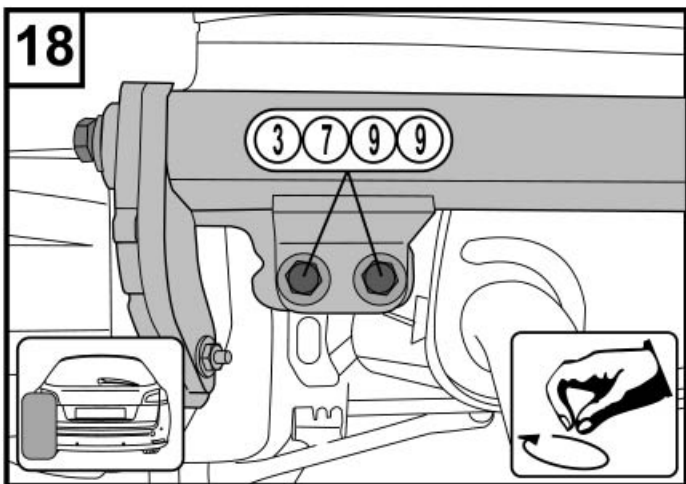
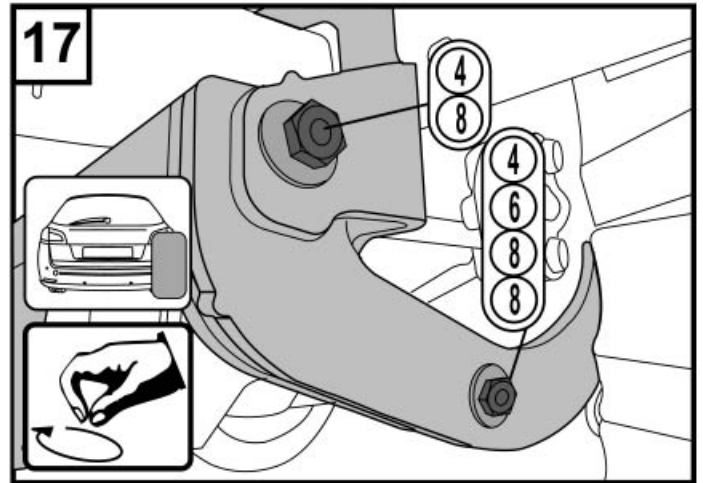
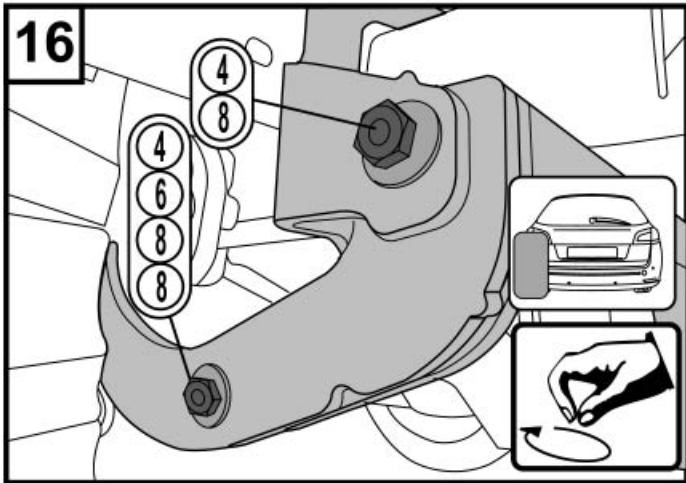
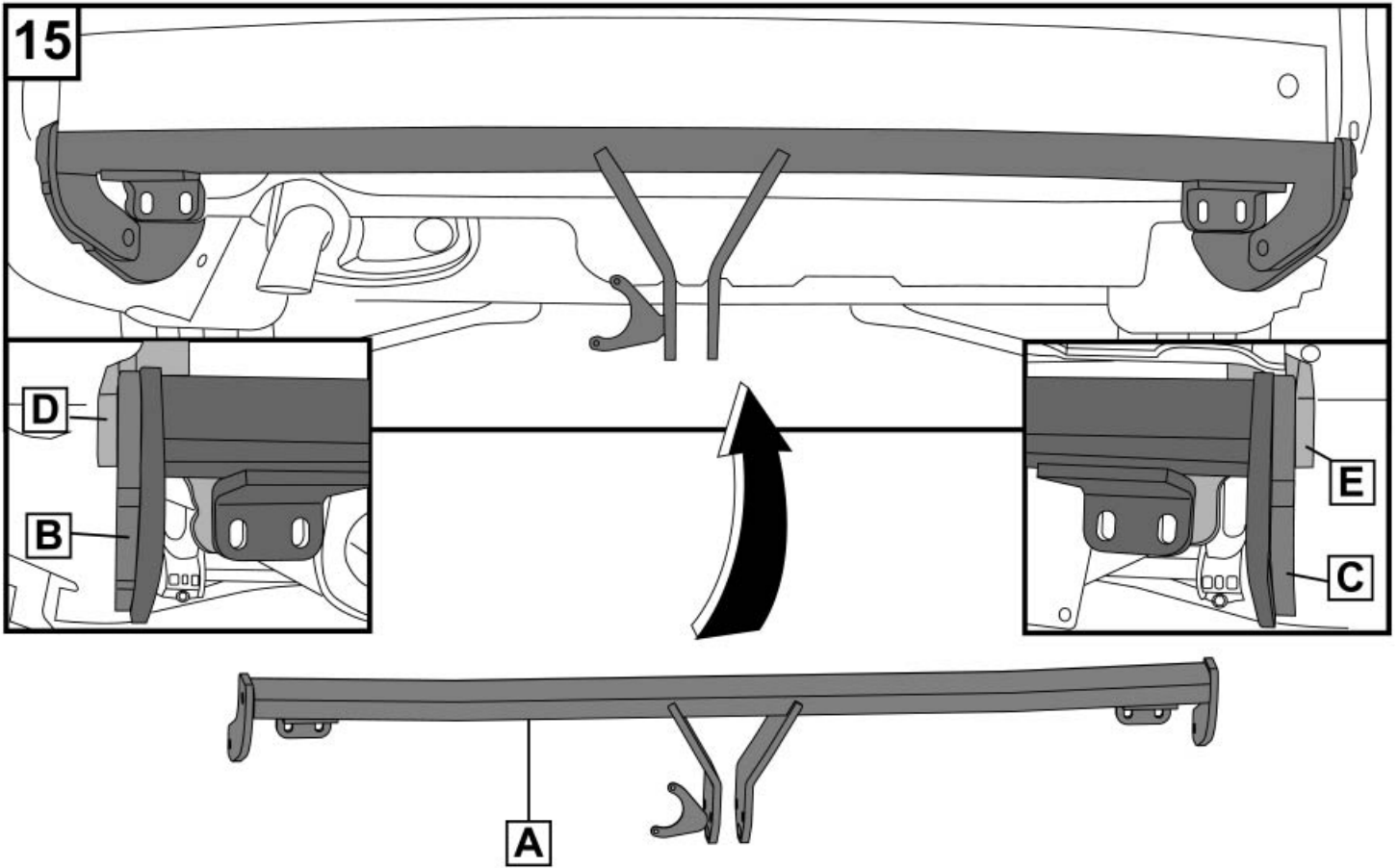

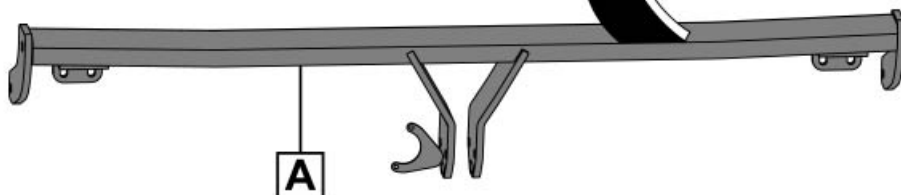
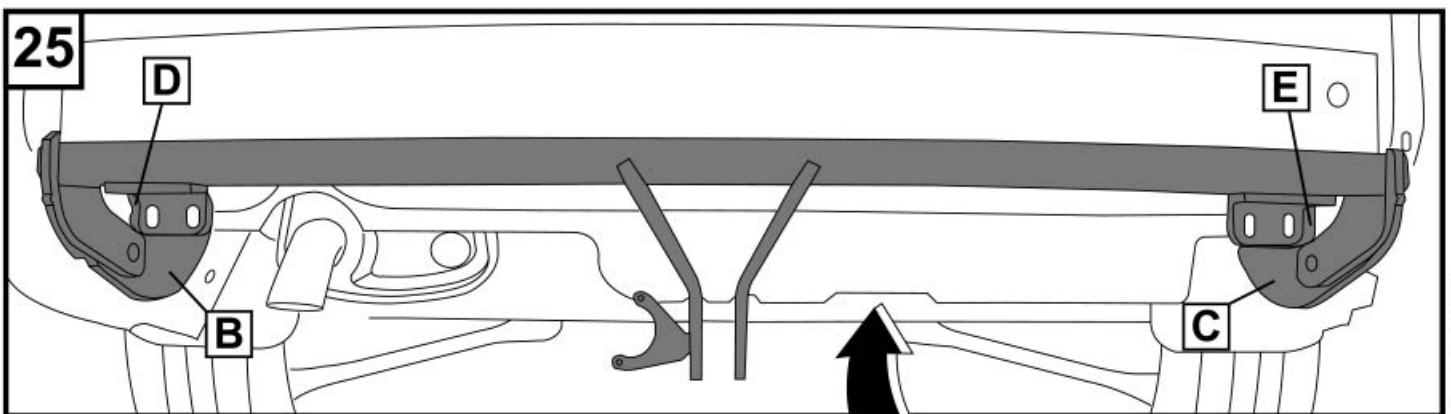
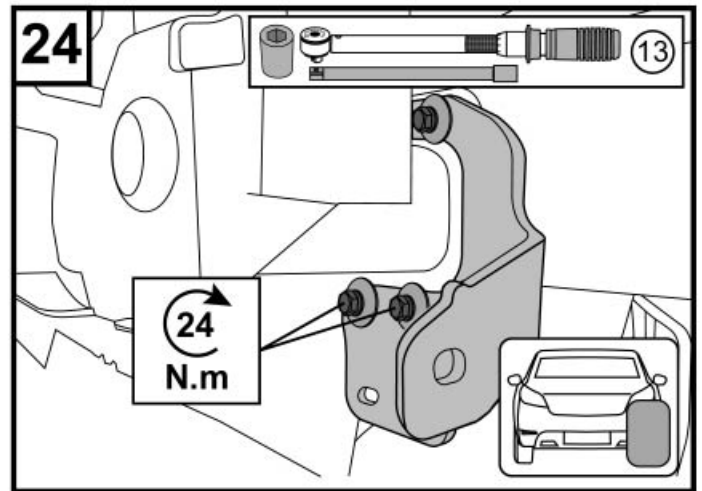
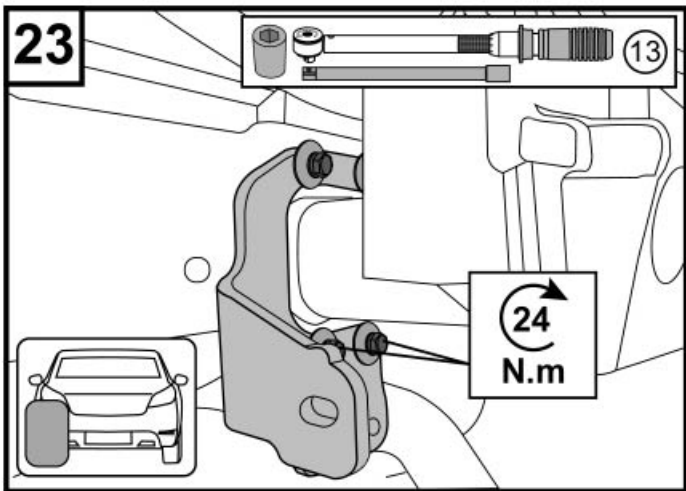
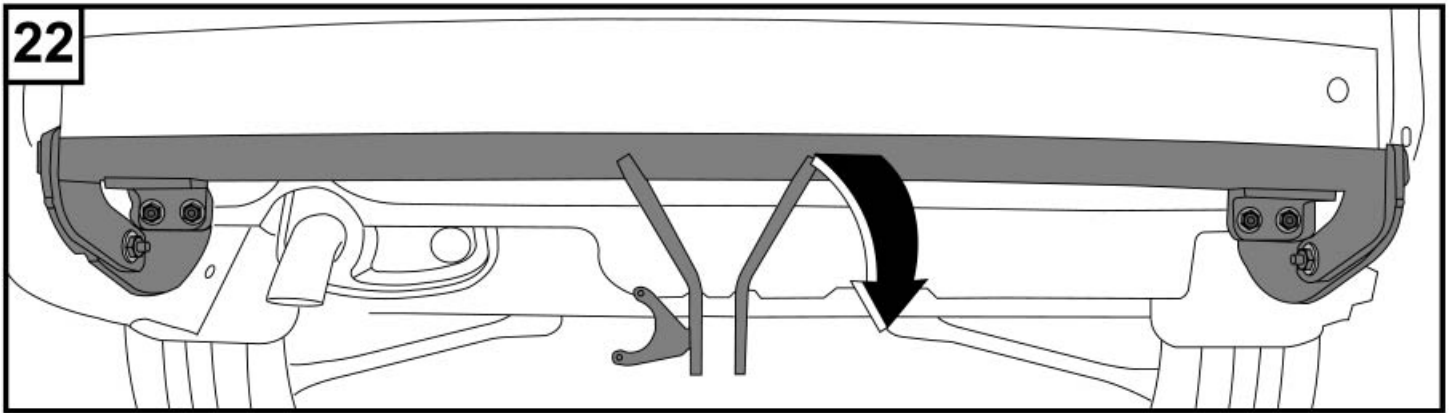
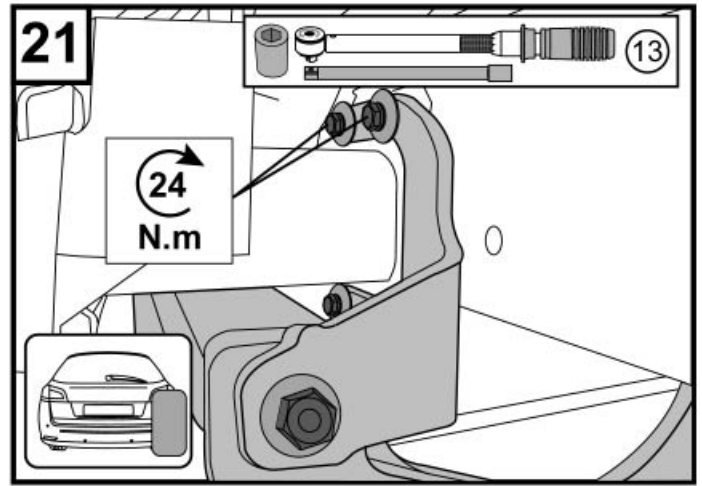
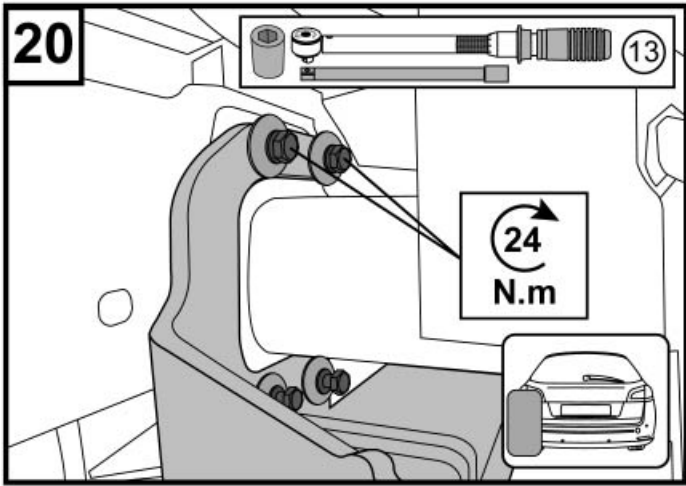

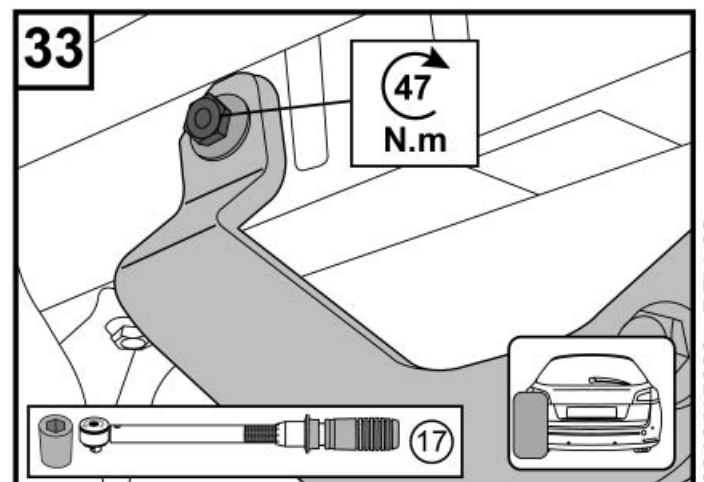
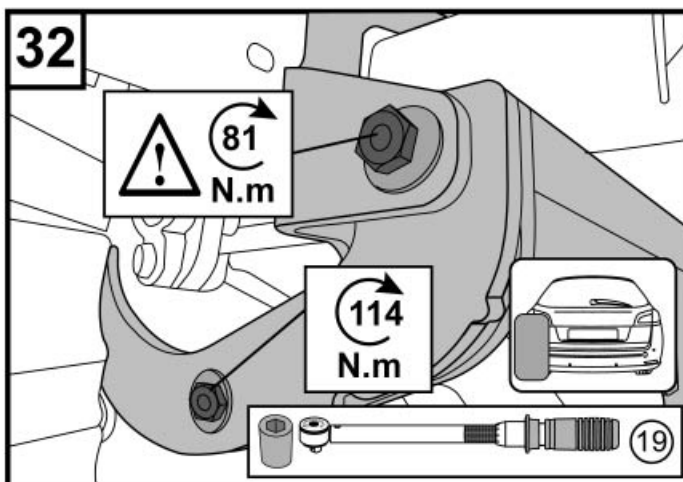
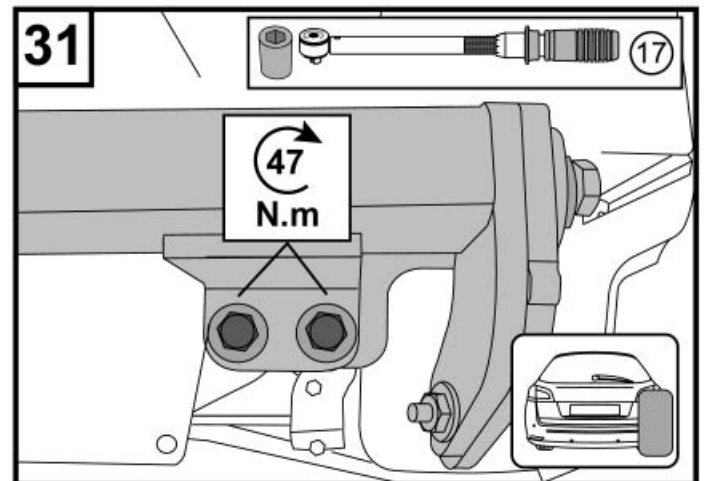
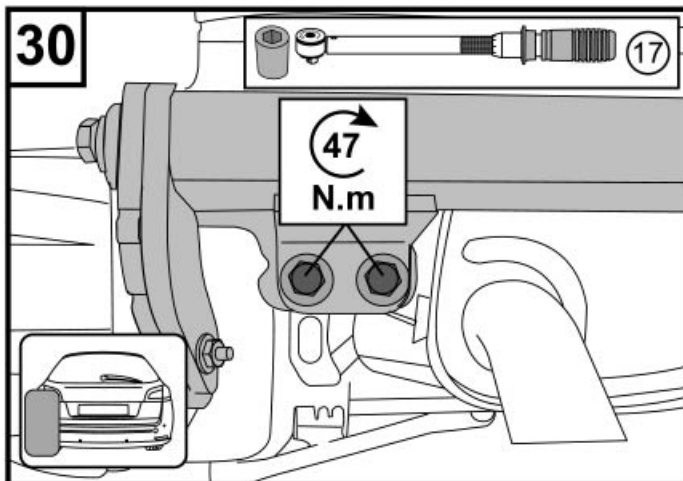
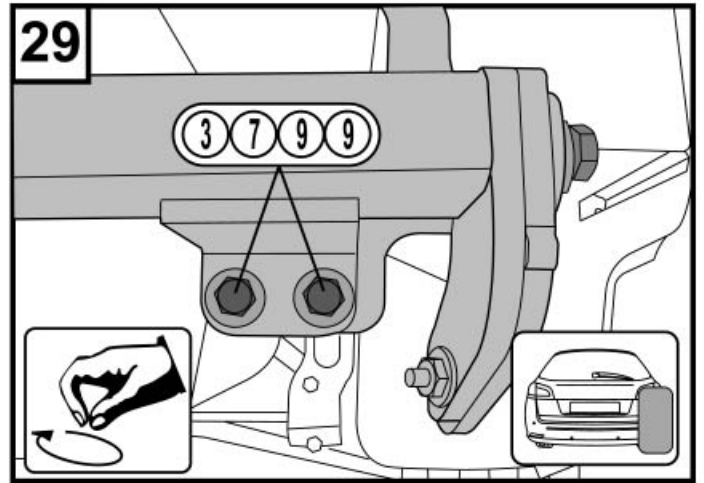
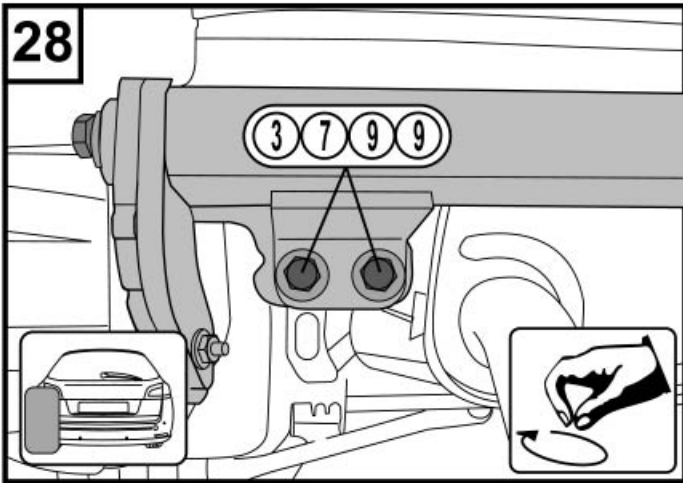
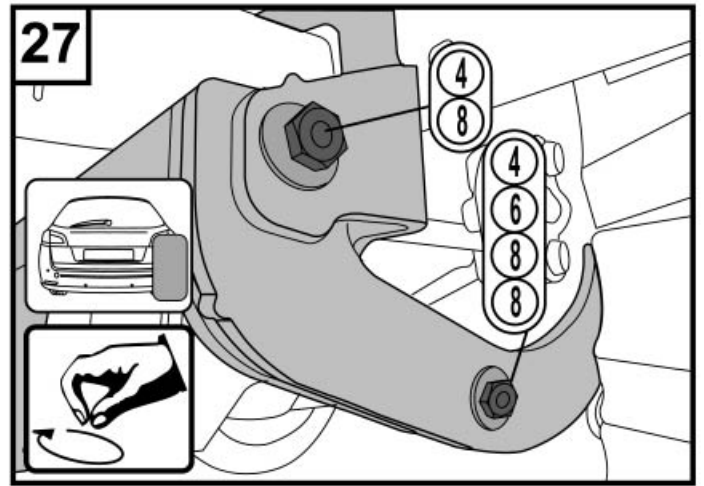
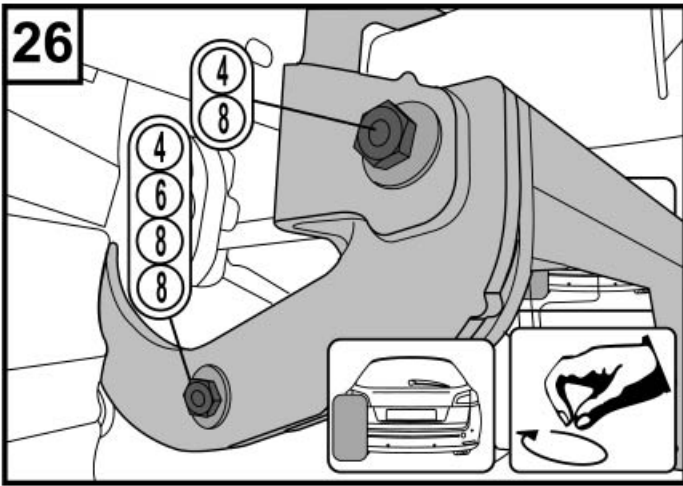

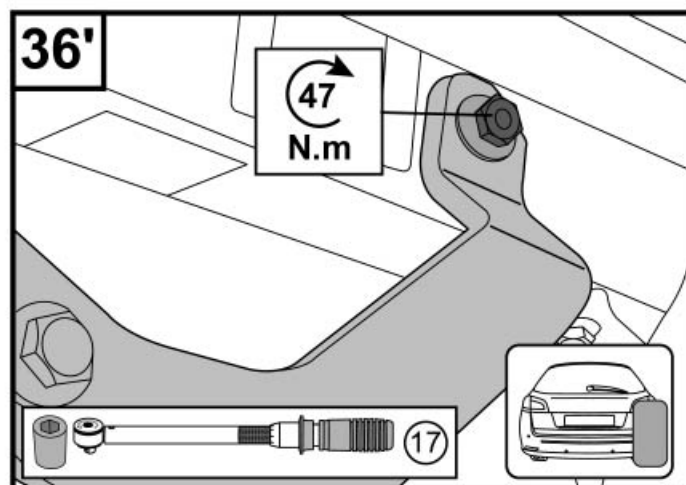
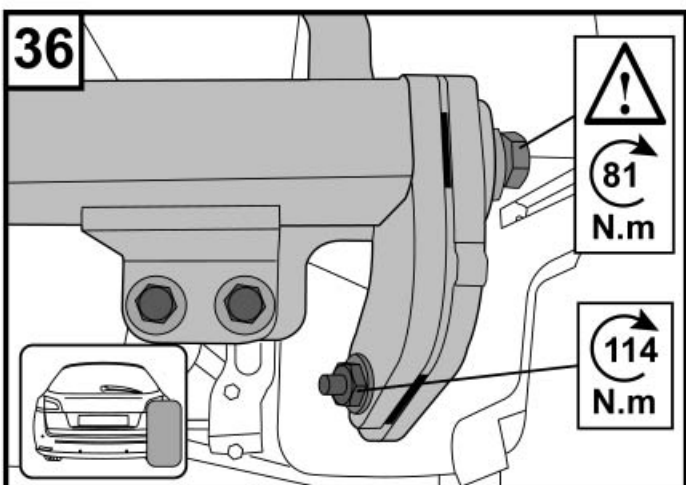
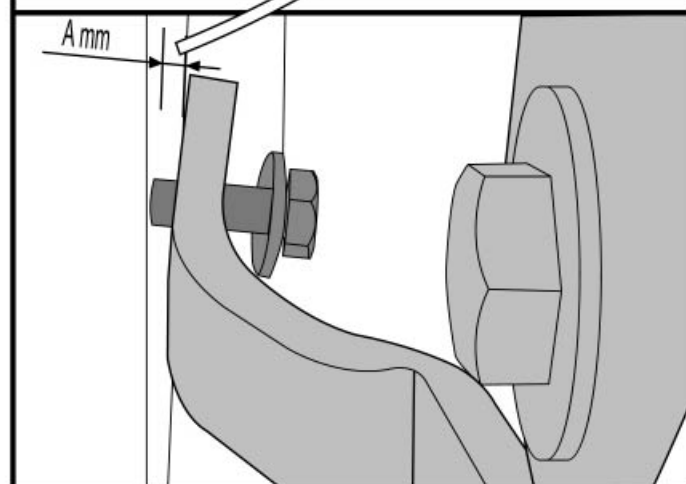
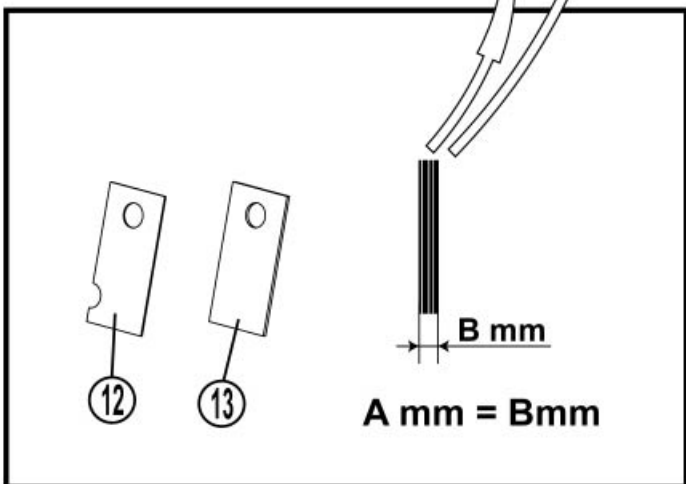
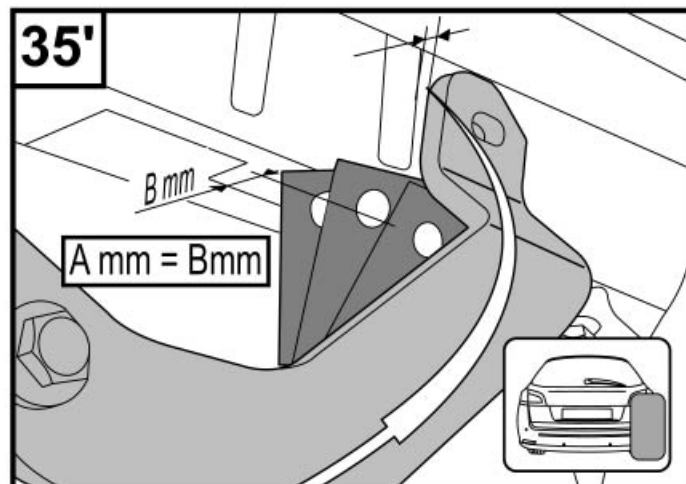
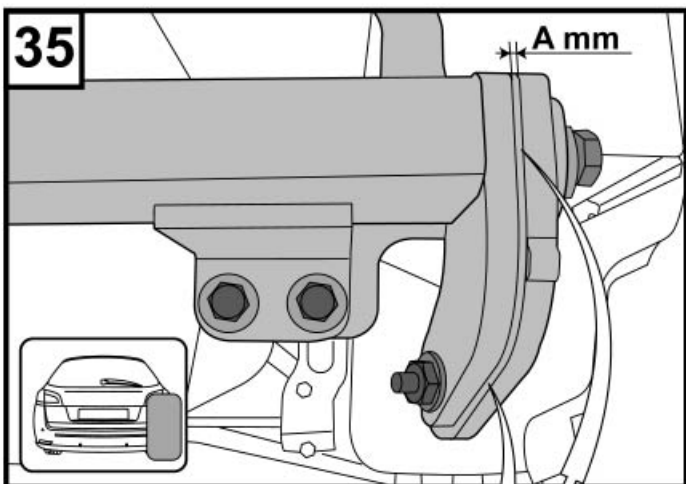
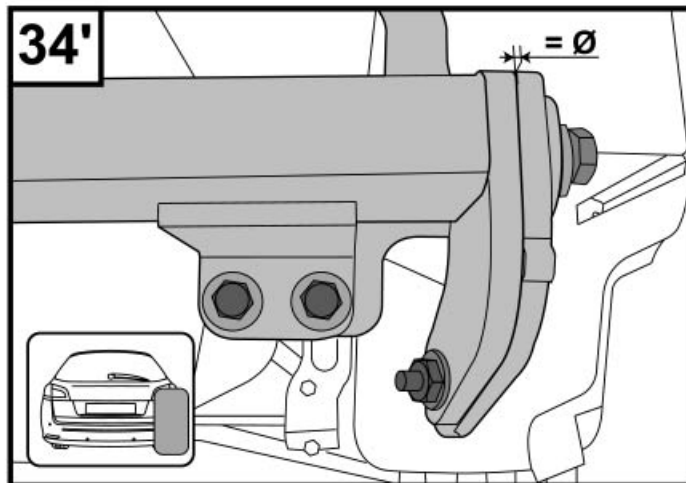
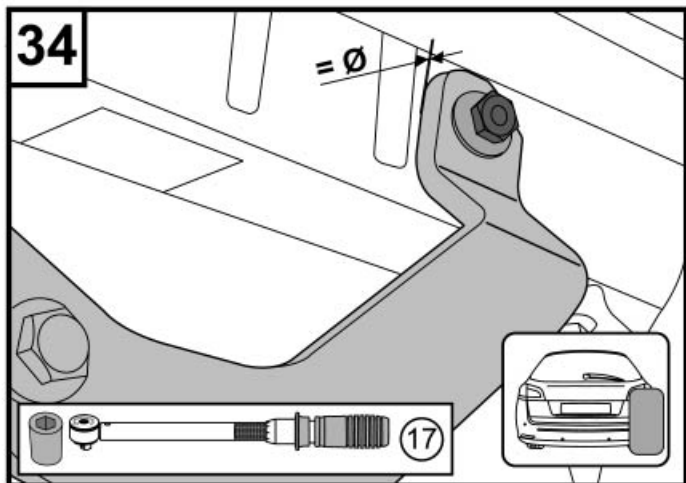

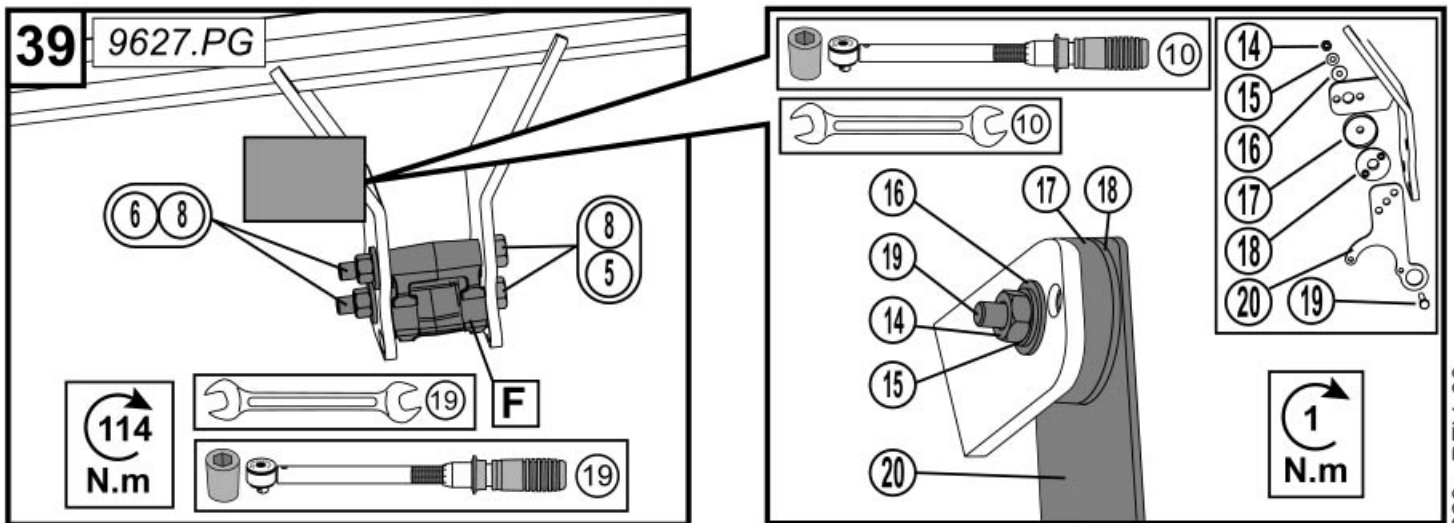
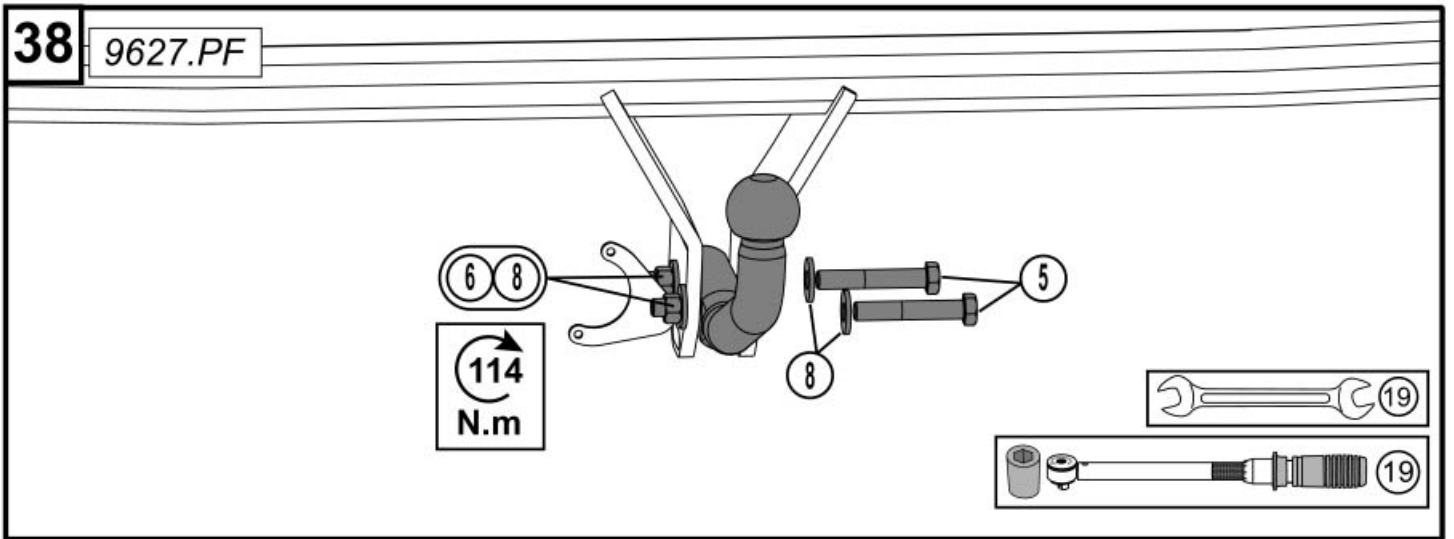
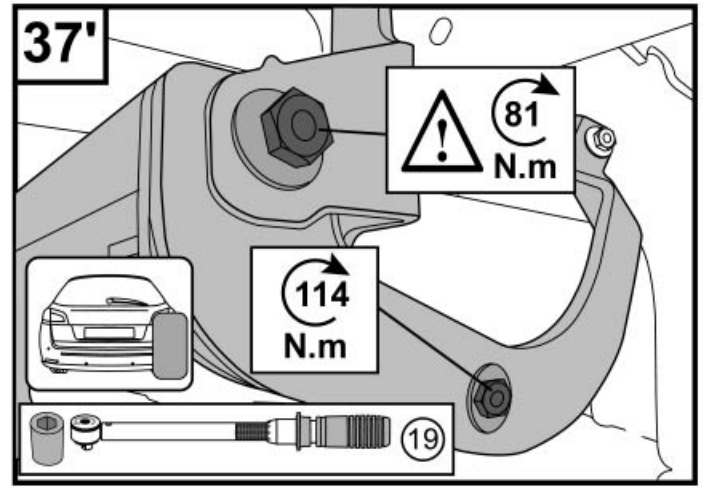
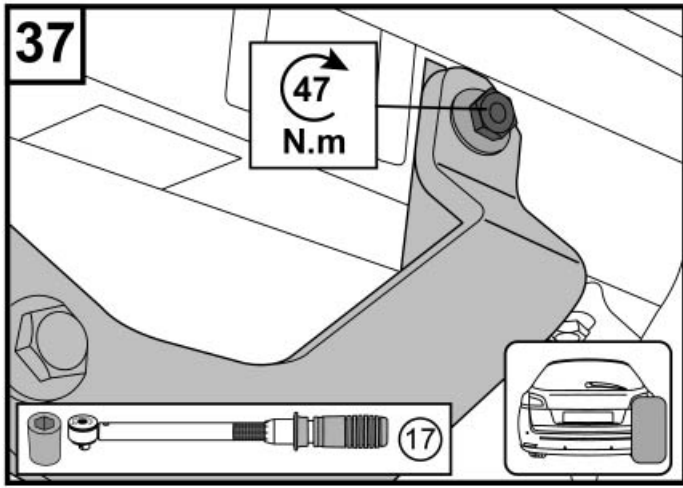

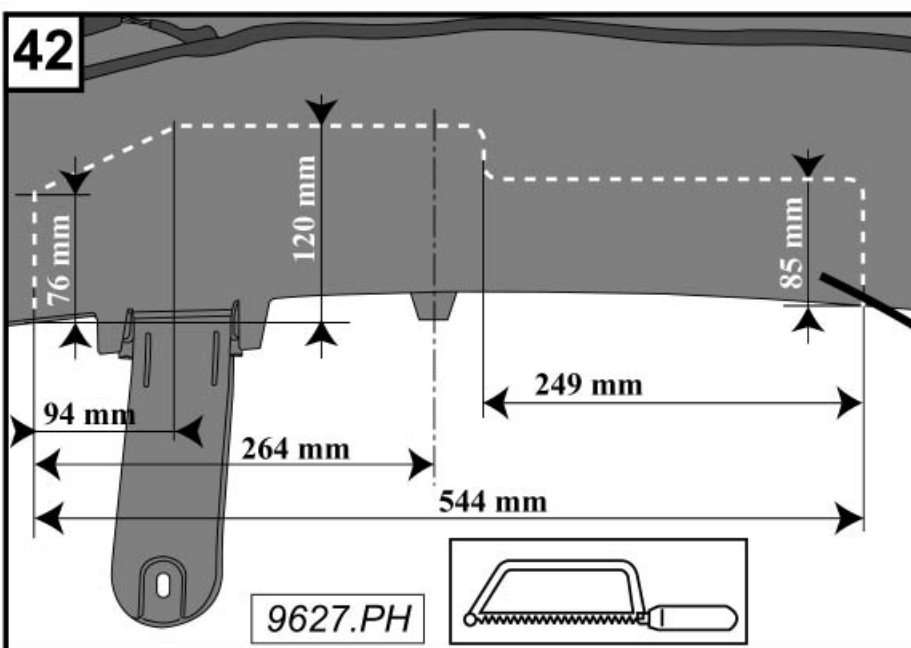
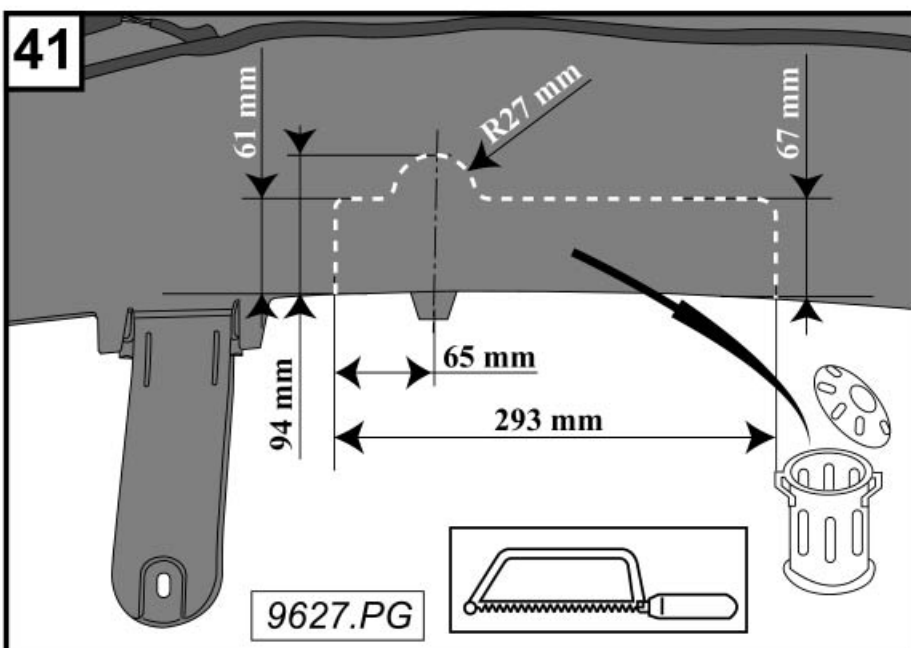
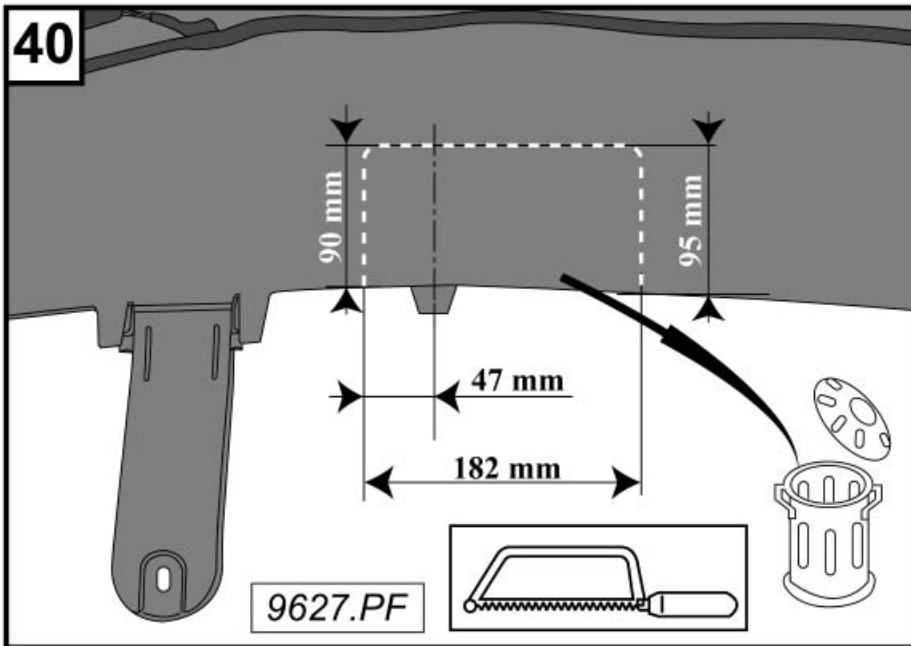

9910115629 - REV. 00

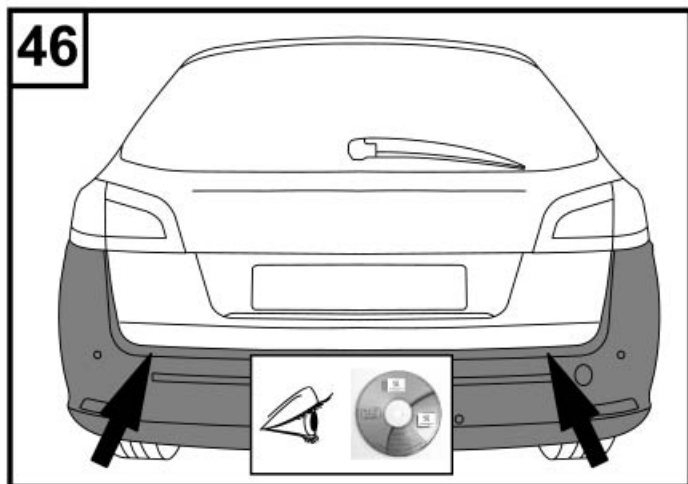
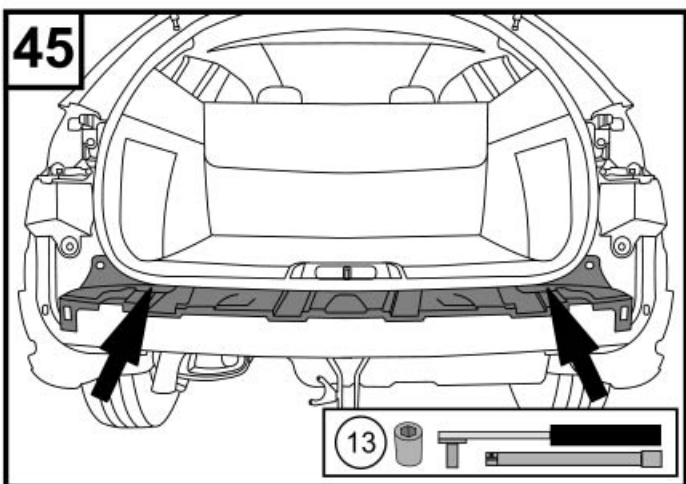
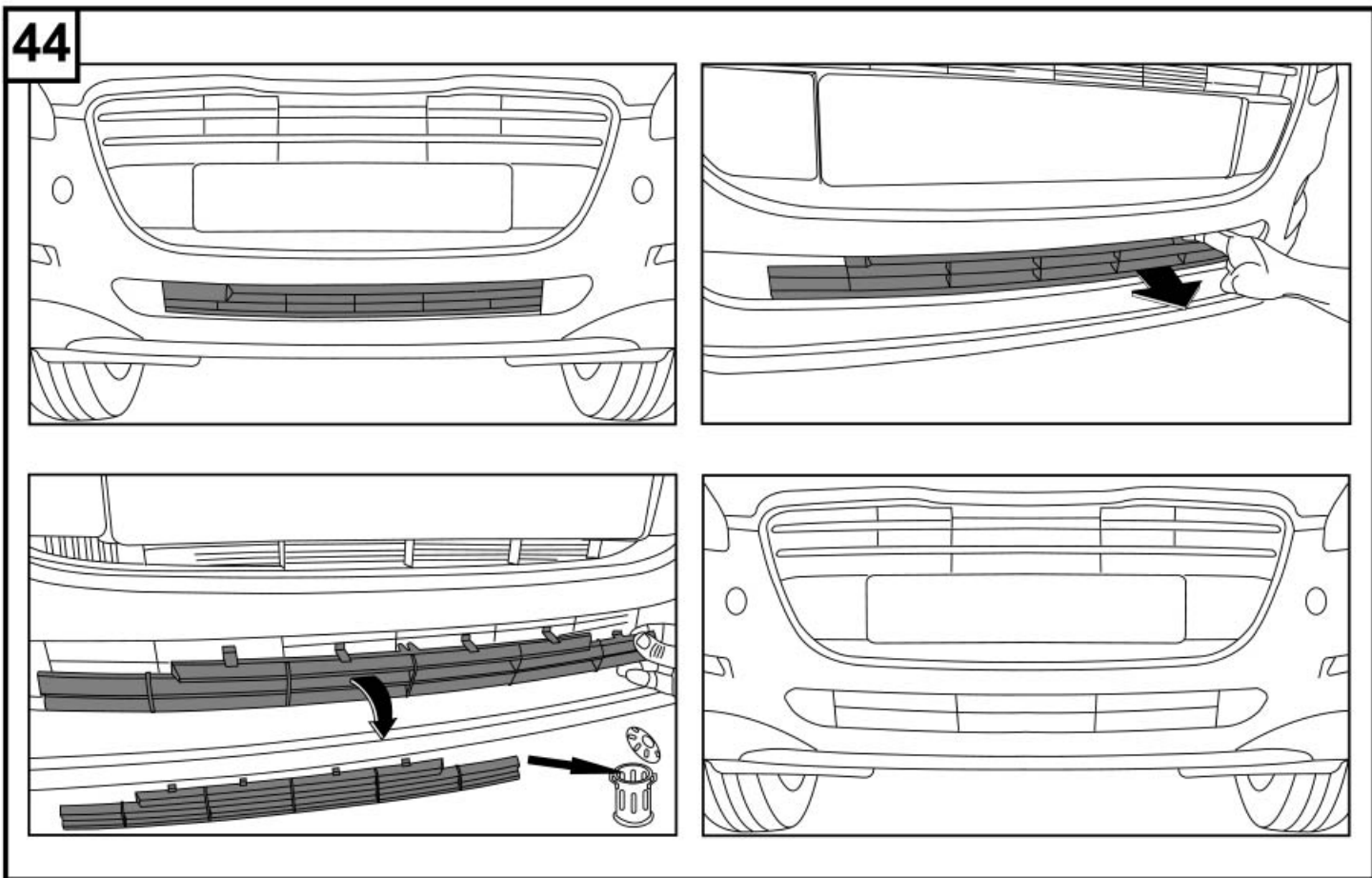
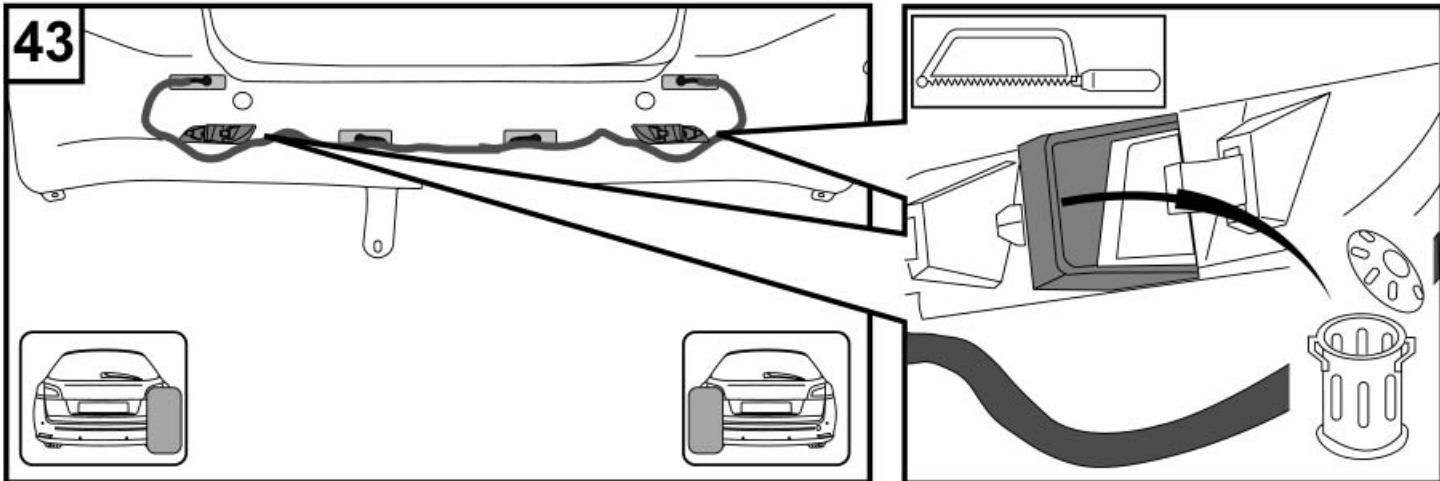

9910115629 - REV. 00

47

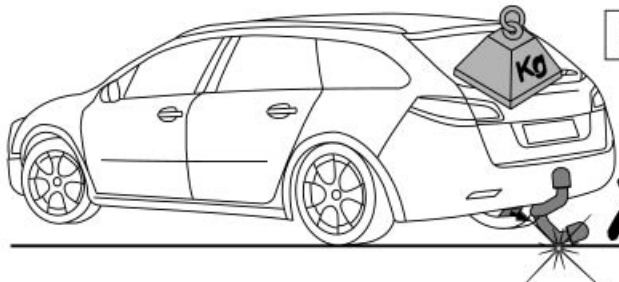
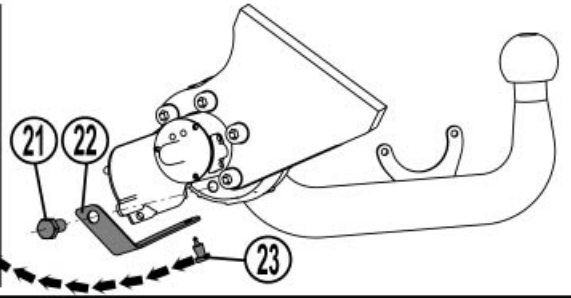
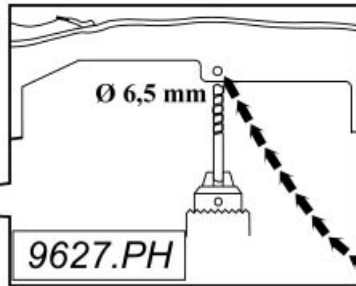
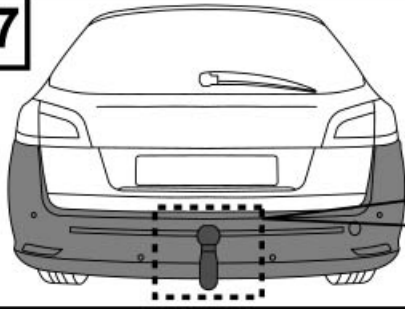

9627.PH

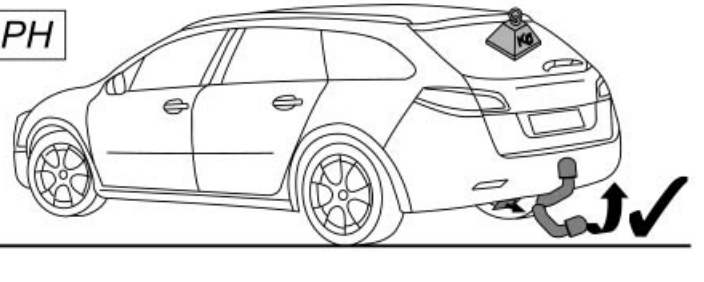

9627.PF

9627.PH

9627.PG

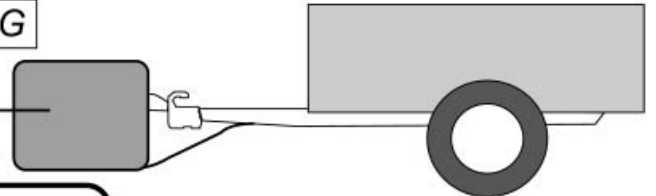
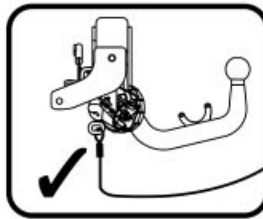
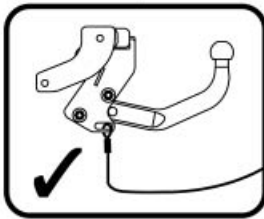
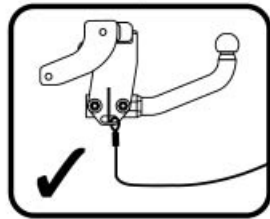

- M8 : 35 N.m
- M10 : 47 N.m
- M12 : 81 N.m
- M12 : 114 N.m

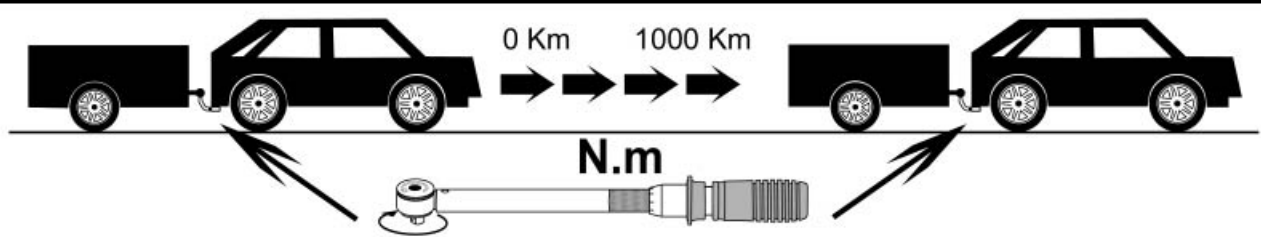
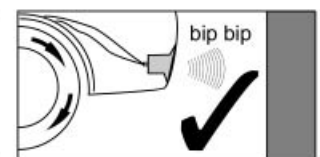
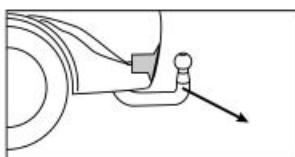
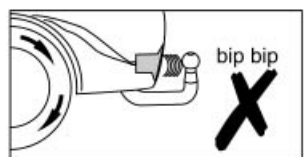
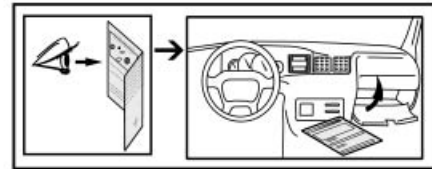

9627.PH

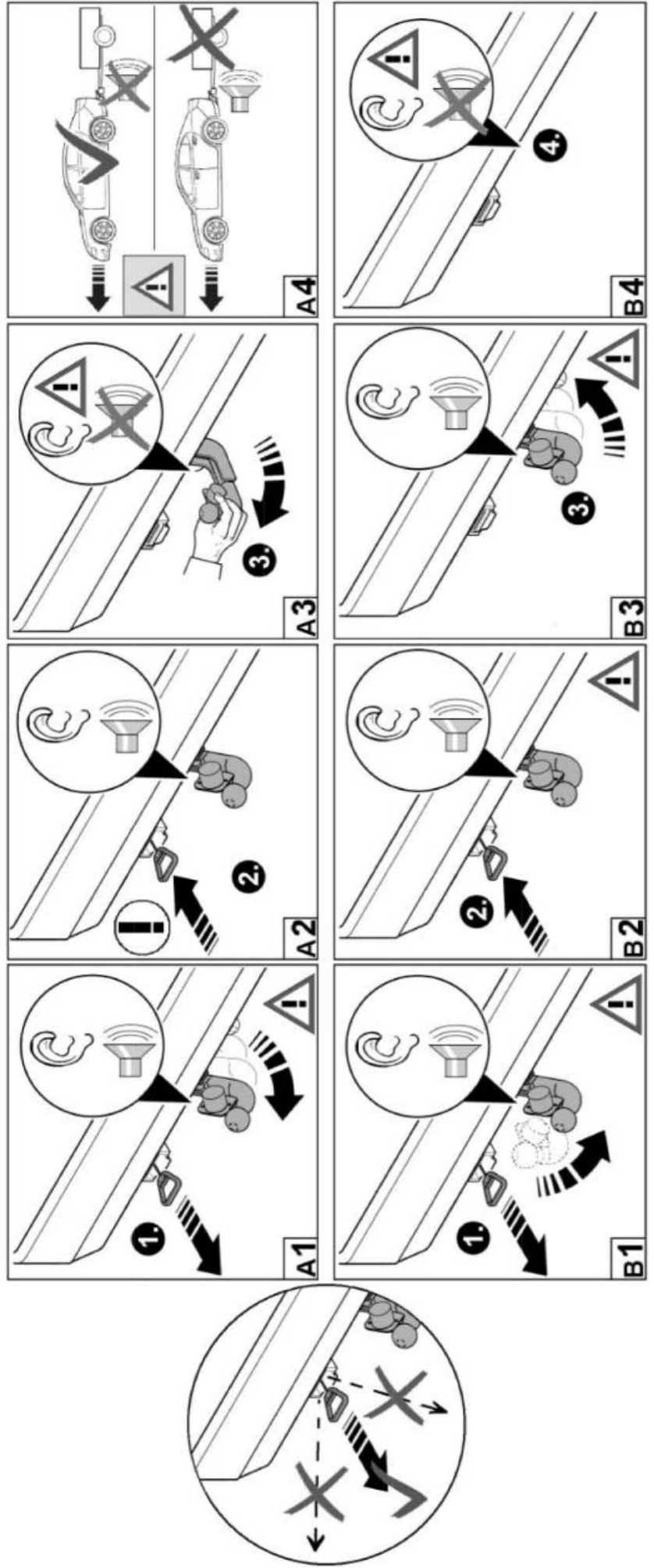
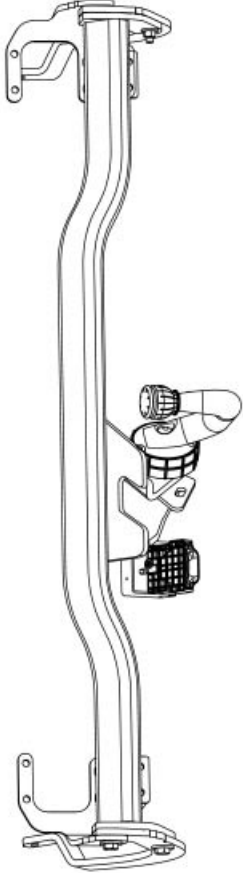



Dispositivo di traino tipo : 9627.PF / 033845 9627.PG / 033846 9627.PH / 033849

Per autoveicoli : PEUGEOT 508 SW

Tipo funzionale : **8E **** / ***

Classe e tipo di attacco : CLASS A50-X

Omologazione : e4 - 00 - 4228 / e4 - 00 - 4227 / e4 - 00 - 4257

Valore D : 10,87 kN

Carico Verticale max. S : 82,5 kg

Larghezza rimorchiabile per Caravan e T.A.T.S. : 2,45m vedere CARTA di CIRCOLAZIONE VEICOLO (motrice) + 70 cm = arrotondare ai 5 cm superiore (vedi D.M.28/05/85)

Massa rimorchiabile : vedi carta di circolazione dell' autoveicolo

Per verificare l'idoneità del dispositivo di traino omologato a norma CEE 94/20, all'installazione sulla vettura su cui si intende procedere al montaggio, compilare la seguente formula (se necessario declassare la massa rimorchiabile :

$$D = \frac{T \times C}{T + C} \times 0,00981 = 10,19 \text{ kN} < D$$

dove : T = Massa Complessiva Max. della motrice (in kg)
C = Massa Rimorchiabile Max. della motrice (in kg)

DA COMPILARE PER IL COLLAUDO

DICHIARAZIONE DI CORRETTO MONTAGGIO : la sottoscritta Ditta dichiara di aver montato in maniera corretta ed in conformità alle prescrizioni sia del costruttore del veicolo che del costruttore del dispositivo stesso il seguente dispositivo di attacco meccanico :

tipo : 9627.PF / 033845 9627.PG / 033846 9627.PH / 033849
dispositiva di attacco sopra indicato è stato installato su autoveicolo
modello : PEUGEOT 508 SW
targa : _____
Data : _____

TIMBRO e FIRMA

Si dichiara inoltre di aver informato l'utente del veicolo sull'USO e MANUTENZIONE del dispositivo stesso.





**THE NETHERLANDS
(NEDERLAND)**



EC TYPE-APPROVAL CERTIFICATE

Communication concerning the:

- type-approval⁽¹⁾
- ~~extension of type approval⁽²⁾~~
- ~~refusal of type approval⁽²⁾~~
- ~~withdrawal of type approval⁽²⁾~~

of a type of a component with regard to Directive 94/20/EC.

Type-approval number ⁽²⁾ : **e4*94/20*4227*00**

Reason for extension : n.a.

Approval mark : See example of type plate

SECTION I

- 0.1. Make (trade name of manufacturer) : Bosal
- 0.2. Type and general commercial description(s) : 033846
- 0.3. Means of identification of type if marked on the component ⁽³⁾ : Type approval number
- 0.3.1. Location of that marking : On type plate
- 0.5. Name and address of manufacturer : Bosal Le Rapide
Rue de Reims
F-51490 Beine Nauroy France
- 0.7. In the case of components and separate technical units, location and method of affixing of the EEC approval mark : On type plate
- 0.8. Name(s) and address(es) of assembly plant(s) : See information document (annex III, item 0.8)



SECTION II

1. Additional information (where applicable) : See Appendix I
2. Technical service responsible for carrying out the tests : RDW
Testbaan|Centrum
Talingweg 76
8218 NX Lelystad
3. Date of test report : 08-11-2010
4. Number of test report : RDW-94/20-6493
5. Remarks (if any) : See Appendix I
6. Place : Zoetermeer
7. Date : 08-11-2010
8. Signature :

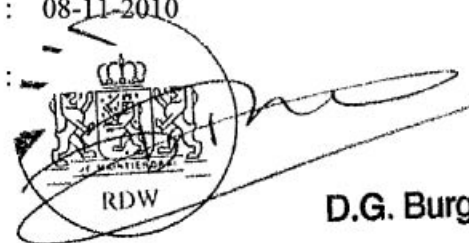

D.G. Burger

9. The index to the information package lodged with the competent authority that has granted type-approval, which may be obtained on request, is attached:
 - Application form relating to annex III and annexed drawings.
 - Drawings and instructions for attachment
 - Fitting instructions

⁽¹⁾ Delete where not applicable.

⁽²⁾ The EEC type-approval number appearing on this document shall consist of all sections outlined in Annex VII to Directive 70/156/EEC as last amended by Directive 92/53/EEC. The component itself shall be marked as prescribed in the relevant separate Directive.

⁽³⁾ In the means of identification of type contains characters not relevant to describe the component types covered by this type-approval certificate such characters shall be represented in the documentation by the symbol “?” (e.g. ABC??123).

APPENDIX I

to EEC type-approval certificate number : e4*94/20*4227*00

concerning the components type-approval of mechanical coupling devices with regard to Directive 94/20/EC.

1. Additional information
- 1.1. Class of the type of coupling : A50-X
- 1.2. Categories or types of vehicles for which the device is designed or restricted : Peugeot 508, (Station Wagon / Break) model year from 2011
- 1.3. Maximum D-value ⁽¹⁾ : 10,87 kN
- 1.4. Maximum vertical load S at the coupling point ⁽¹⁾ : 82,5 kg
- 1.5. Maximum load U at the fifth wheel coupling point ⁽¹⁾ : ----- tonnes
- 1.6. Maximum V-value ¹⁾ : ----- kN
- 1.7. Instructions for attachment of the coupling type to the vehicle and photographs or drawings of the fixing points at the vehicle give by the manufacturer; additional information if the use of the coupling type is restricted to special types of vehicles : See fitting instructions
- 1.8. Information on the fitting of special towing brackets or mounting plates ⁽¹⁾ : See fitting instructions
5. Remarks ⁽²⁾ : The installation of the coupling device on the vehicle must be checked according to the requirements given in Annex VII (see Annex I Paragraph 5.10.)

⁽¹⁾ Delete where not applicable.

⁽²⁾ Including information as to whether fifth wheel couplings are unsuitable for positive steering.



**THE NETHERLANDS
(NEDERLAND)****EC TYPE-APPROVAL CERTIFICATE**

Communication concerning the:

- type-approval⁽¹⁾
- ~~extension of type approval⁽²⁾~~
- ~~refusal of type approval⁽²⁾~~
- ~~withdrawal of type approval⁽²⁾~~

of a type of a component with regard to Directive 94/20/EC.

Type-approval number ⁽²⁾ : **e4*94/20*4228*00**
Reason for extension : n.a.
Approval mark : See example of type plate

SECTION I

- 0.1. Make (trade name of manufacturer) : Bosal
- 0.2. Type and general commercial description(s) : 033845
- 0.3. Means of identification of type if marked on the component ⁽³⁾ : Type approval number
- 0.3.1. Location of that marking : On type plate
- 0.5. Name and address of manufacturer : Bosal Le Rapide
Rue de Reims
F-51490 Beine Nauroy France
- 0.7. In the case of components and separate technical units, location and method of affixing of the EEC approval mark : On type plate
- 0.8. Name(s) and address(es) of assembly plant(s) : See information document
(annex III, item 0.8)



SECTION II

1. Additional information (where applicable) : See Appendix I
2. Technical service responsible for carrying out the tests : RDW
Testbaan|Centrum
Talingweg 76
8218 NX Lelystad
3. Date of test report : 09-11-2010
4. Number of test report : RDW-94/20-6494
5. Remarks (if any) : See Appendix I
6. Place : Zoetermeer
7. Date : 09-11-2010
8. Signature :

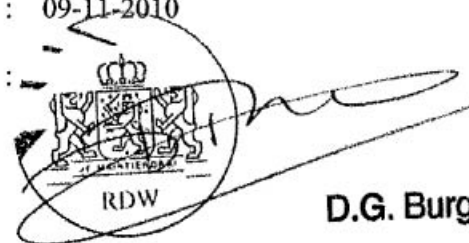
A circular stamp of the RDW (Rijksdienst voor Ondernemend Nederland) logo is shown, featuring a crown and the text 'RDW'. A handwritten signature in black ink is written over the stamp and extends to the right.

D.G. Burger

9. The index to the information package lodged with the competent authority that has granted type-approval, which may be obtained on request, is attached:
 - Application form relating to annex III and annexed drawings.
 - Drawings and instructions for attachment
 - Fitting instructions

⁽¹⁾ Delete where not applicable.

⁽²⁾ The EEC type-approval number appearing on this document shall consist of all sections outlined in Annex VII to Directive 70/156/EEC, as last amended by Directive 92/53/EEC. The component itself shall be marked as prescribed in the relevant separate Directive.

⁽³⁾ In the means of identification of type contains characters not relevant to describe the component types covered by this type-approval certificate such characters shall be represented in the documentation by the symbol “?” (e.g. ABC??123).

APPENDIX I

to EEC type-approval certificate number : e4*94/20*4228*00

concerning the components type-approval of mechanical coupling devices with regard to Directive 94/20/EC.

1. Additional information
 - 1.1. Class of the type of coupling : A50-X
 - 1.2. Categories or types of vehicles for which the device is designed or restricted : See fitting instructions
 - 1.3. Maximum D-value ⁽¹⁾ : 10,87 kN
 - 1.4. Maximum vertical load S at the coupling point ⁽¹⁾ : 82,5 kg
 - 1.5. Maximum load U at the fifth wheel coupling point ⁽¹⁾ : ----- tonnes
 - 1.6. Maximum V-value ⁽¹⁾ : ----- kN
 - 1.7. Instructions for attachment of the coupling type to the vehicle and photographs or drawings of the fixing points at the vehicle give by the manufacturer; additional information if the use of the coupling type is restricted to special types of vehicles : See fitting instructions
 - 1.8. Information on the fitting of special towing brackets or mounting plates ⁽¹⁾ : See fitting instructions
5. Remarks ⁽²⁾ : The installation of the coupling device on the vehicle must be checked according to the requirements given in Annex VII (see Annex I Paragraph 5.10.)

⁽¹⁾ Delete where not applicable.

⁽²⁾ Including information as to whether fifth wheel couplings are unsuitable for positive steering.





THE NETHERLANDS
(NEDERLAND)



EC TYPE-APPROVAL CERTIFICATE

Communication concerning the:

- type-approval⁽¹⁾
- extension of type-approval⁽²⁾
- refusal of type-approval⁽²⁾
- withdrawal of type-approval⁽²⁾

of a type of a component with regard to Directive 94/20/EC.

Type-approval number ⁽²⁾ : e4*94/20*4257*00
Reason for extension : n.a.
Approval mark : See example of type plate

SECTION I

- 0.1. Make (trade name of manufacturer) : Bosal
- 0.2. Type and general commercial description(s) : 033849
- 0.3. Means of identification of type if marked on the component ⁽³⁾ : Type approval number
 - 0.3.1. Location of that marking : On type plate
- 0.5. Name and address of manufacturer : Bosal Le Rapide
Rue de Reims
F-51490 Beine Nauroy France
- 0.7. In the case of components and separate technical units, location and method of affixing of the EEC approval mark : On type plate
- 0.8. Name(s) and address(es) of assembly plant(s) : See information document (annex III, item 0.8)



SECTION II

1. Additional information (where applicable) : See Appendix I
2. Technical service responsible for carrying out the tests : RDW
Testbaan|Centrum
Talingweg 76
8218 NX Lelystad
3. Date of test report : 24-11-2010
4. Number of test report : RDW-94/20-6528
5. Remarks (if any) : See Appendix I
6. Place : Zoetermeer
7. Date : 24-11-2010
8. Signature :

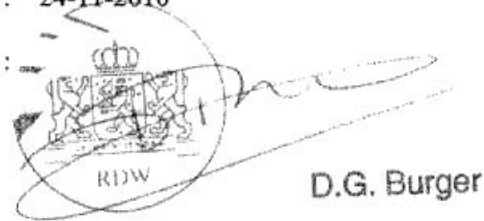

D.G. Burger

9. The index to the information package lodged with the competent authority that has granted type-approval, which may be obtained on request, is attached:
 - Application form relating to annex III and annexed drawings.
 - Drawings and instructions for attachment
 - Fitting instructions

⁽¹⁾ Delete where not applicable.

⁽²⁾ The EEC type-approval number appearing on this document shall consist of all sections outlined in Annex VII to Directive 70/156/EEC, as last amended by Directive 92/53/EEC. The component itself shall be marked as prescribed in the relevant separate Directive.

⁽³⁾ In the means of identification of type contains characters not relevant to describe the component types covered by this type-approval certificate such characters shall be represented in the documentation by the symbol “?” (e.g. ABC??123).

APPENDIX I

to EEC type-approval certificate number : e4*94/20*4257*00

concerning the components type-approval of mechanical coupling devices with regard to Directive 94/20/EC.

1. Additional information
- 1.1. Class of the type of coupling : A50-X
- 1.2. Categories or types of vehicles for which the device is designed or restricted : Peugeot 508 Station Wagon / Break
Model year 2011
- 1.3. Maximum D-value ⁽¹⁾ : 10,87 kN
- 1.4. Maximum vertical load S at the coupling point ⁽¹⁾ : 82,5 kg
- 1.5. Maximum load U at the fifth wheel coupling point ⁽¹⁾ : ----- tonnes
- 1.6. Maximum V-value ⁽¹⁾ : ----- kN
- 1.7. Instructions for attachment of the coupling type to the vehicle and photographs or drawings of the fixing points at the vehicle give by the manufacturer; additional information if the use of the coupling type is restricted to special types of vehicles : See fitting instructions
- 1.8. Information on the fitting of special towing brackets or mounting plates ⁽¹⁾ : See fitting instructions
5. Remarks ⁽²⁾ : The installation of the coupling device on the vehicle must be checked according to the requirements given in Annex VII (see Annex I Paragraph 5.10.)

⁽¹⁾ Delete where not applicable.

⁽²⁾ Including information as to whether fifth wheel couplings are unsuitable for positive steering.

