

Réf. : 98 232 886 80  
16 316 891 80  
NOT 3879

# 208 (P21) CORSA (P2JO)



FR NOTICE DE POSE A USAGE PROFESSIONNEL / LES PHOTOS ET LES DESSINS NE SONT PAS CONTRACTUEL  
GB FITTING INSTRUCTIONS FOR PROFESSIONAL FITTERS / THE PHOTOGRAPHS AND THE DRAWINGS ARE NOT CONTRACTUAL  
ES INSTRUCCIONES DE MONTAJE PARA USO PROFESIONAL / LES FOTOGRAFÍAS Y LOS DIBUJOS NO SON CONTRACTUALES  
P MANUAL DE MONTAGEM PARA UTILIZAÇÃO PROFISSIONAL' / AS FOTOGRAFIAS E OS DESENHOS NÃO SÃO CONTRATUAIS  
DE MONTAGEANLEITUNG FÜR PROFESSIONNELLEN EINSATZ / DIE FOTOS UND DIE ZEICHNUNGEN SIND NICHT VERTRAGLICH  
IT ISTRUZIONI DI POSA AD USO PROFESSIONALE / LE FOTOGRAFIE ED I DISEGNI NON SONO CONTRATTUALI  
NL MONTAGEHANDLEIDING VOOR PROFESSIONEEL GEBRUIK / DE FOTO'S EN DE TEKENINGEN ZIJN NIET CONTRACTUEEL

**PEUGEOT - OPEL**

**CLASS : A 50 X**  
**N° Homologation ECER55**

<b>E24</b>	55R-01 0486	D	7,00 KN
	TYPE SI 261	S	55 kg

Réf. 16 316 891 80 - 98 232 886 80

**siarr** WESTFALIA AUTOMOTIVE **Made in FRANCE**

**S = 55 Kg**

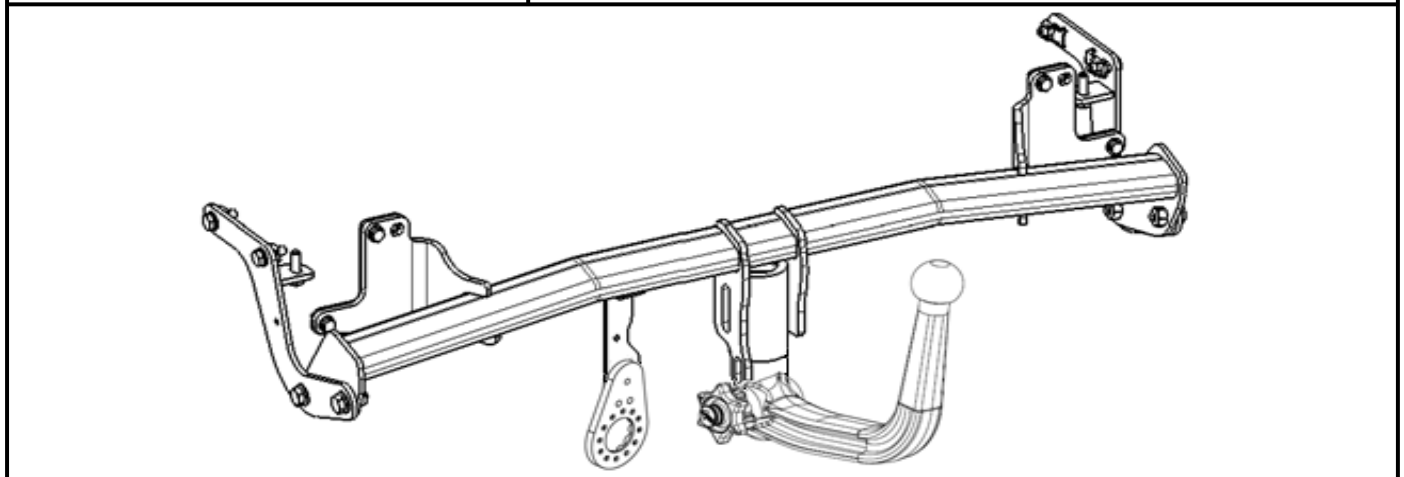



Date de création : 09/07/2019







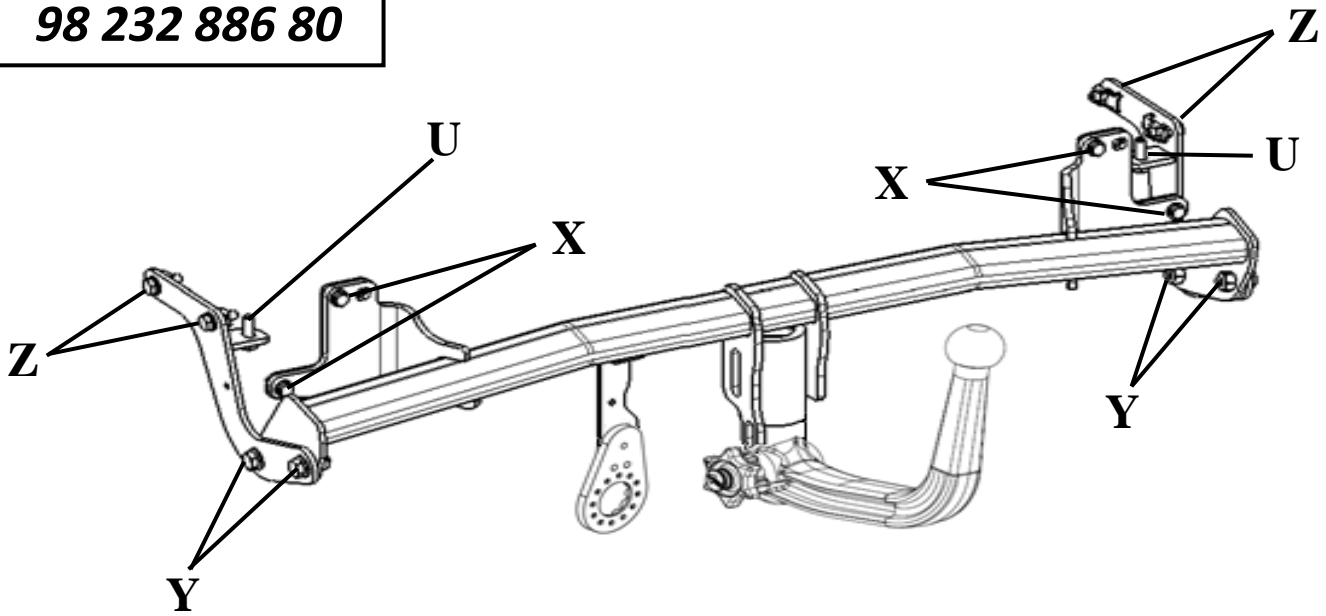





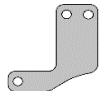



Indice d'évolution : A

Date de modification : 26/09/2023

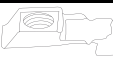
**16 316 891 80**

**98 232 886 80**



VISSERIE		QTÉ
<b>X</b>	 HM 8 x 35 - cl 10.9 - 25 Nm	x 4
	 CS 8 / 18	x 4
	 4 mm	x 2
<b>Y</b>	 HM 12 x 40 - cl 10.9 - 110 Nm	x 4
	 M12 - cl 10	x 4
	 CS 12	x 4
	 1 mm	x 2
	 2 mm	x 2
<b>Z</b>	 HM 10 x 30 - cl 10.9 - 60 Nm	x 4
	 CS 10 / 20	x 4
	 CL4860 1 150	x 4
<b>U</b>	 HM10x30 - cl 10.9 - 60 Nm	x 2
	 CS 10 / 20	x 2
		x 1
		x 1
		x 1

Date de création : 09/07/2019

Indice d'évolution : A

Date de modification : 26/09/2023

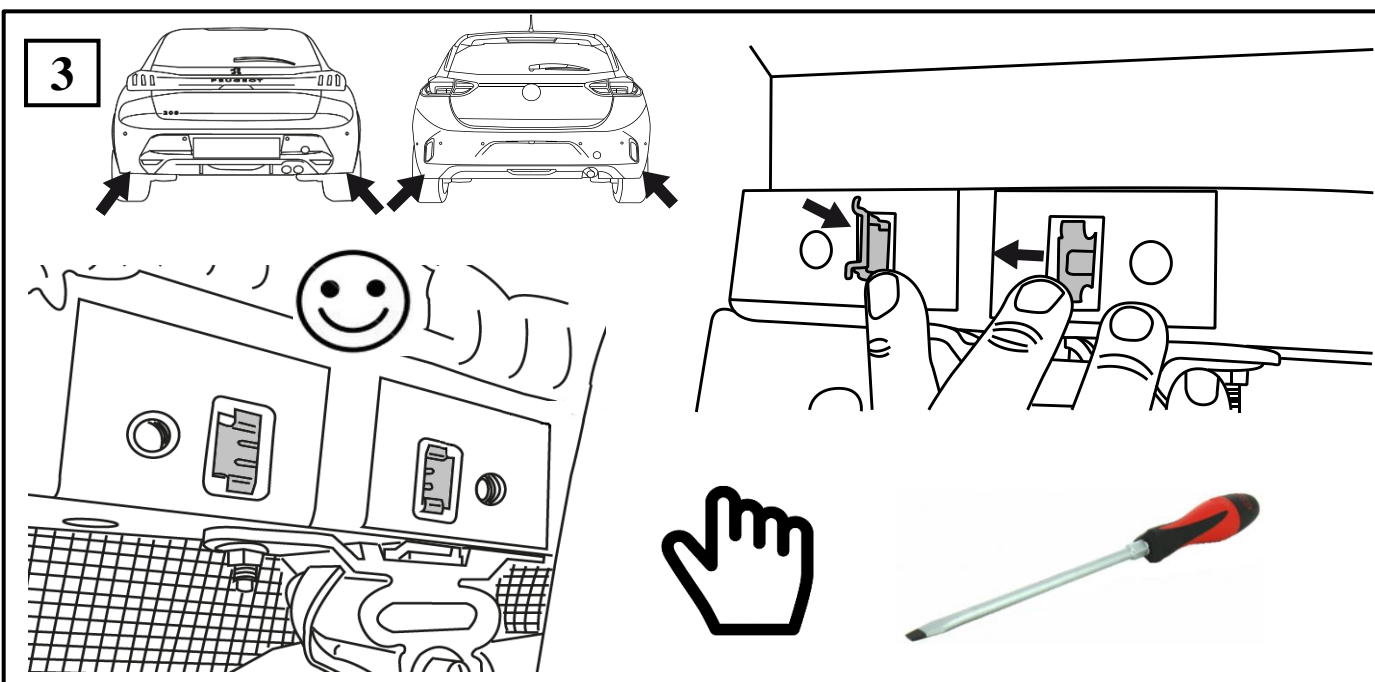
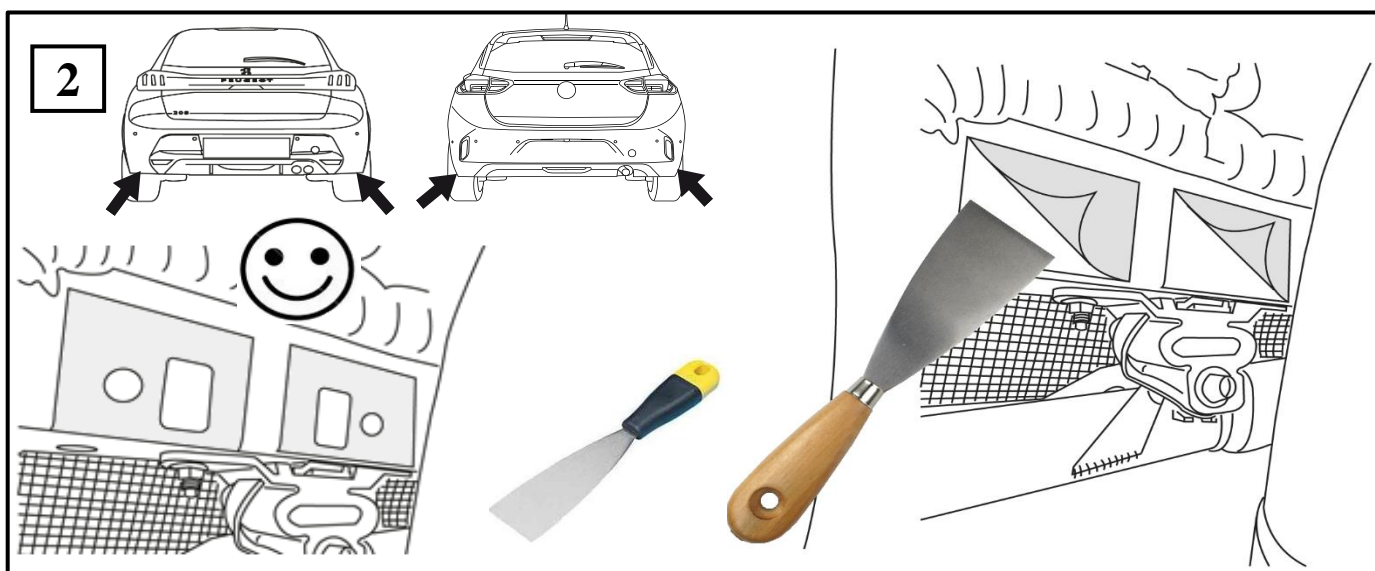
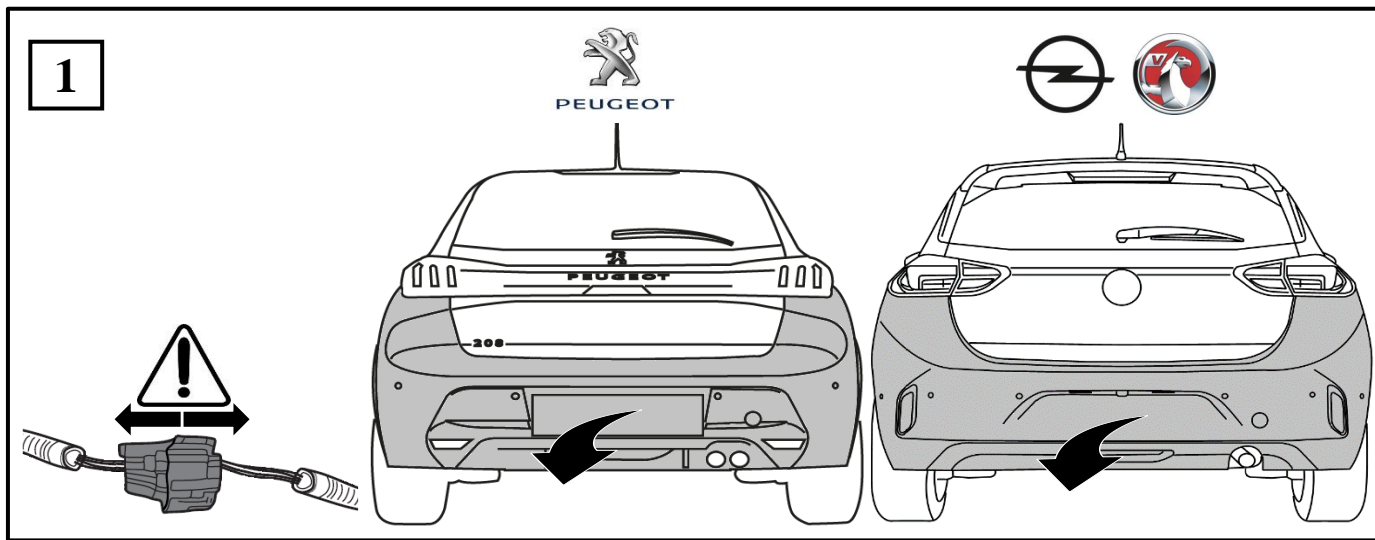

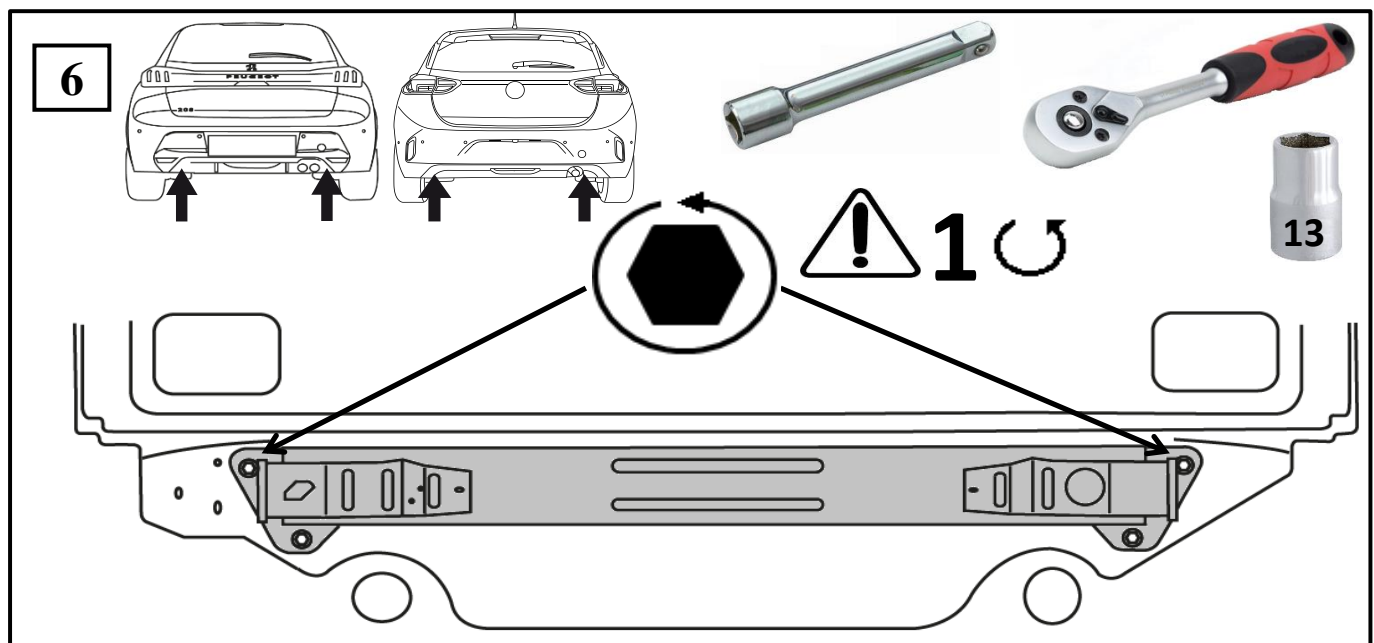
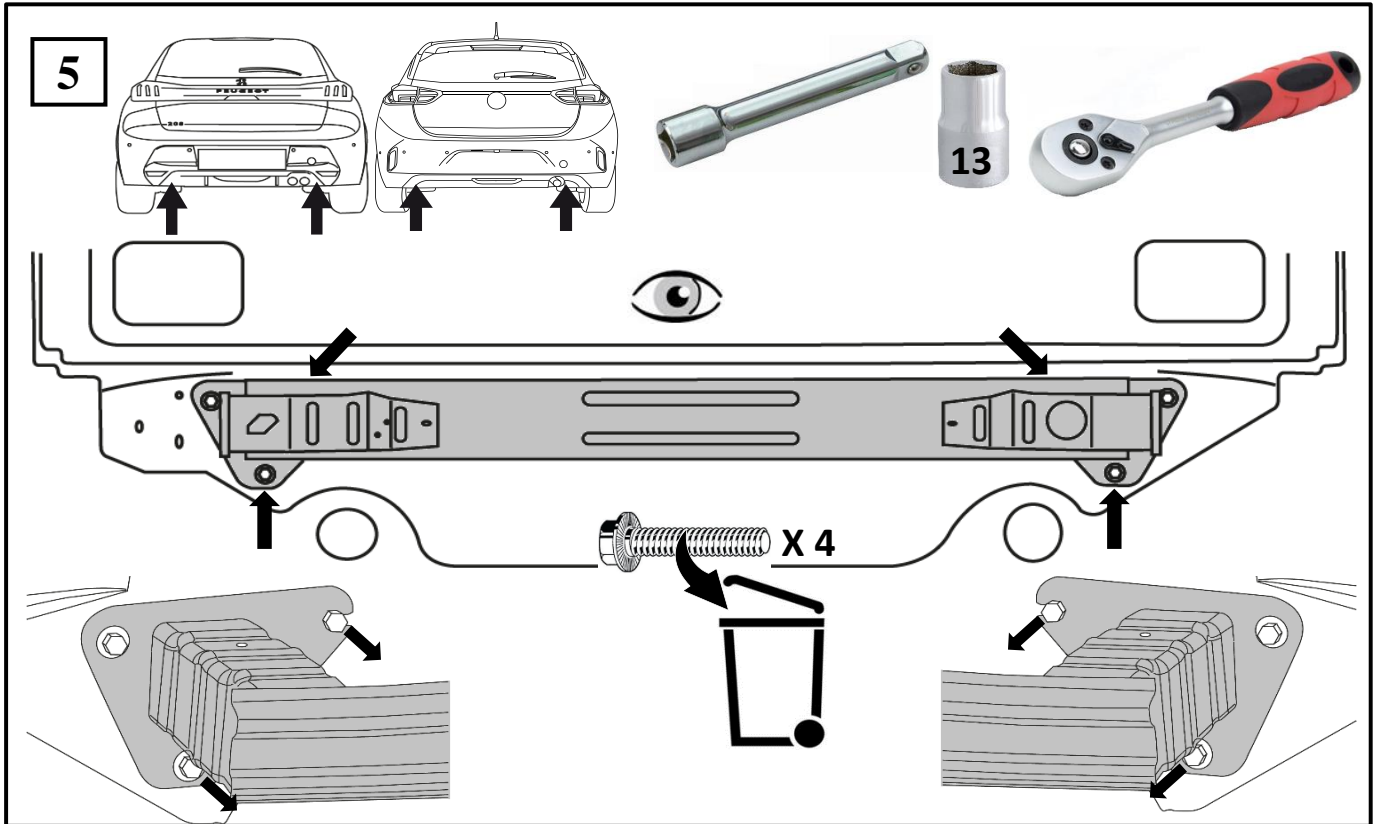
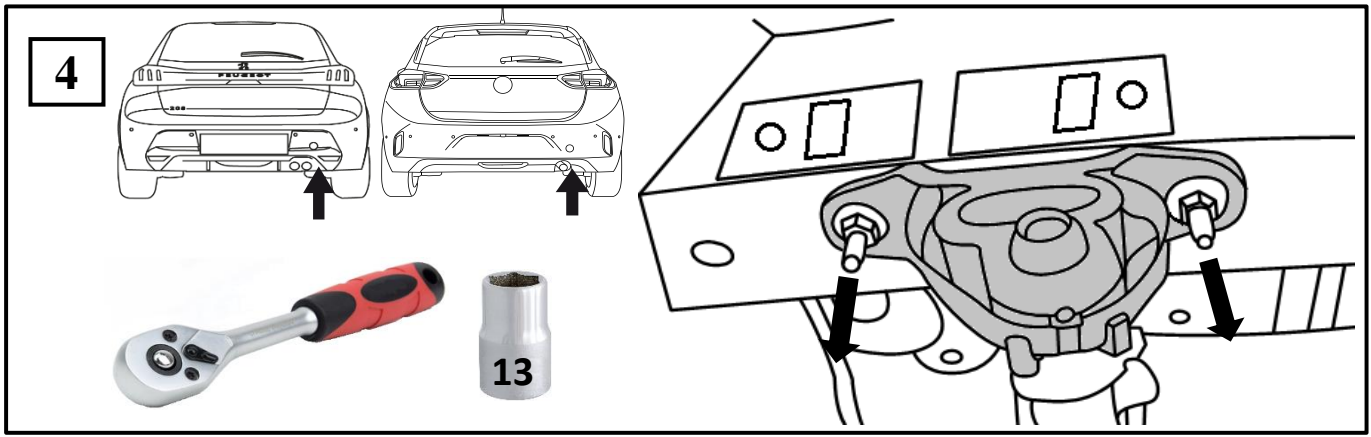

Date de création : 09/07/2019

Indice d'évolution : A

Date de modification : 26/09/2023

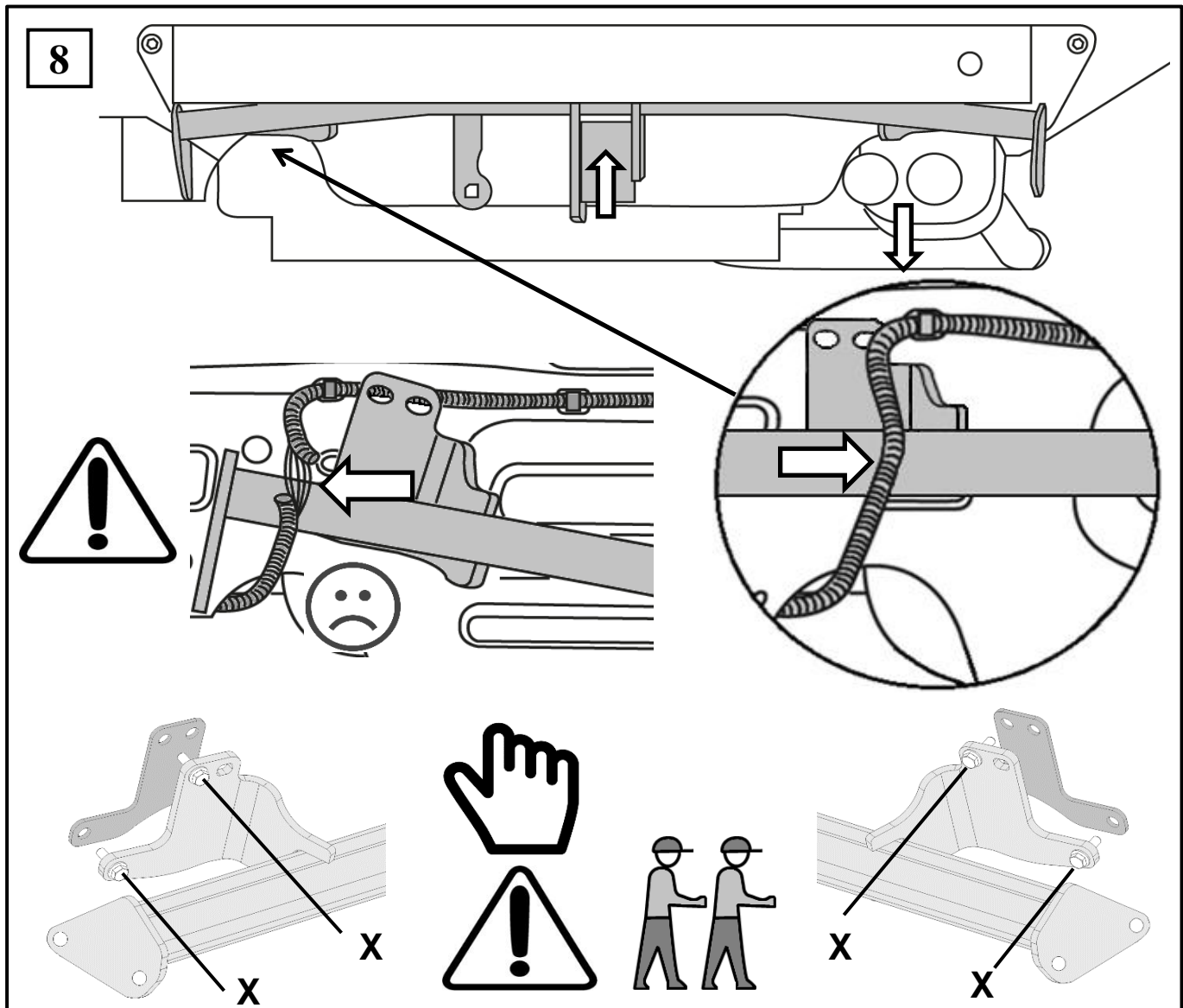
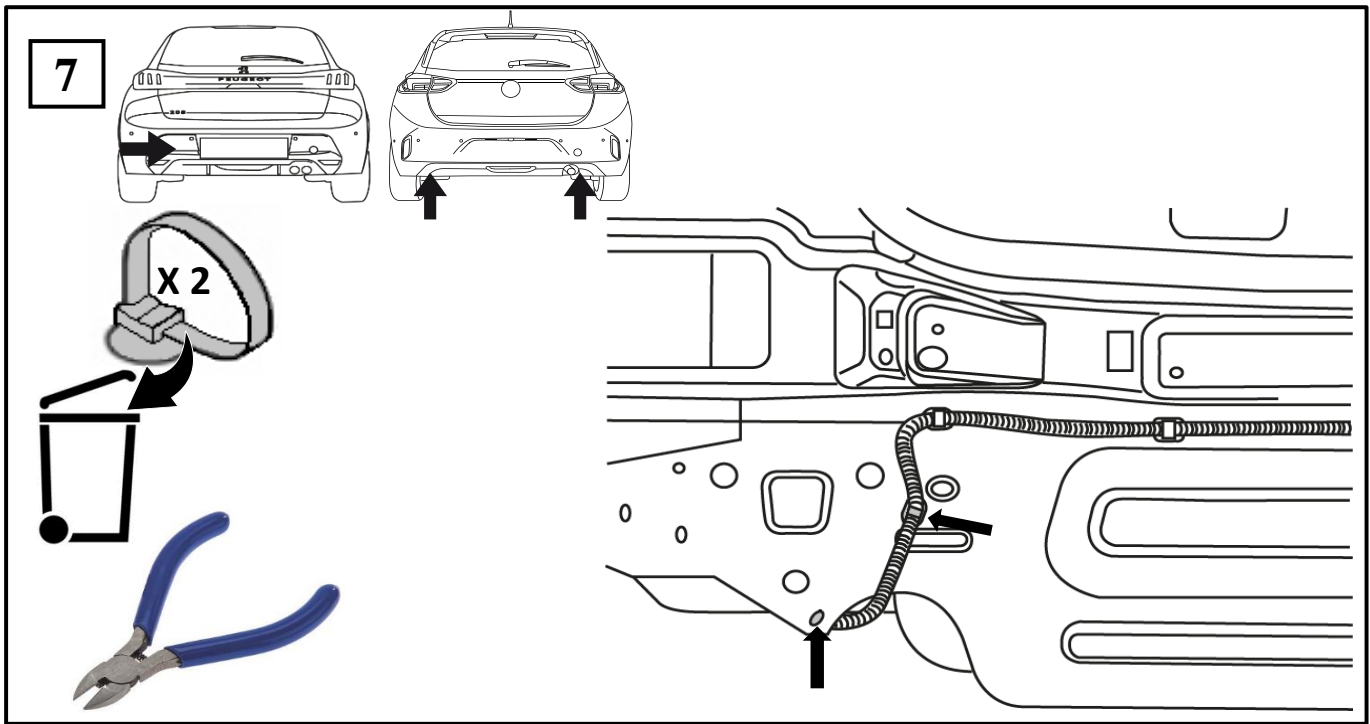

Date de création : 09/07/2019

Indice d'évolution : A

Date de modification : 26/09/2023

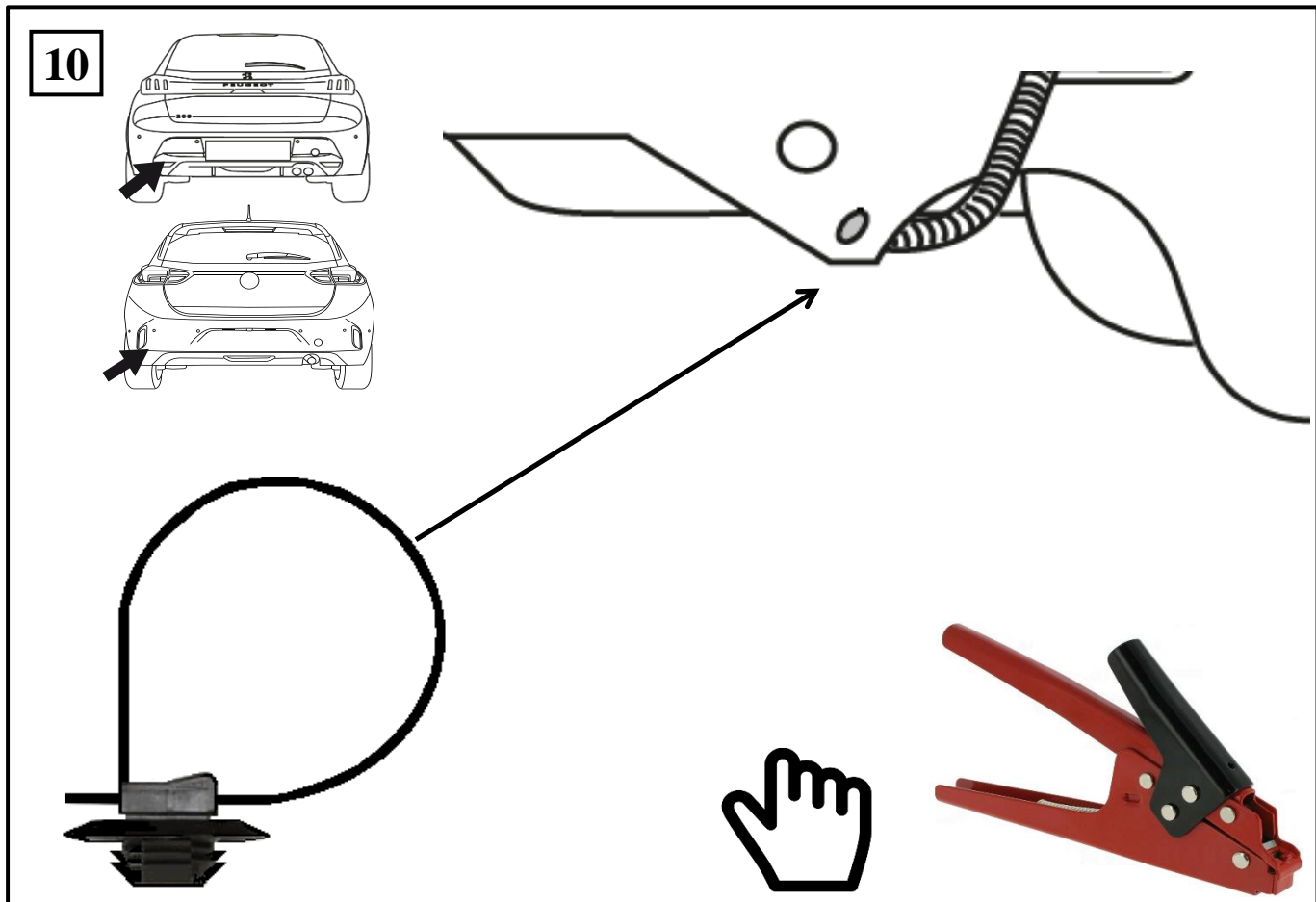
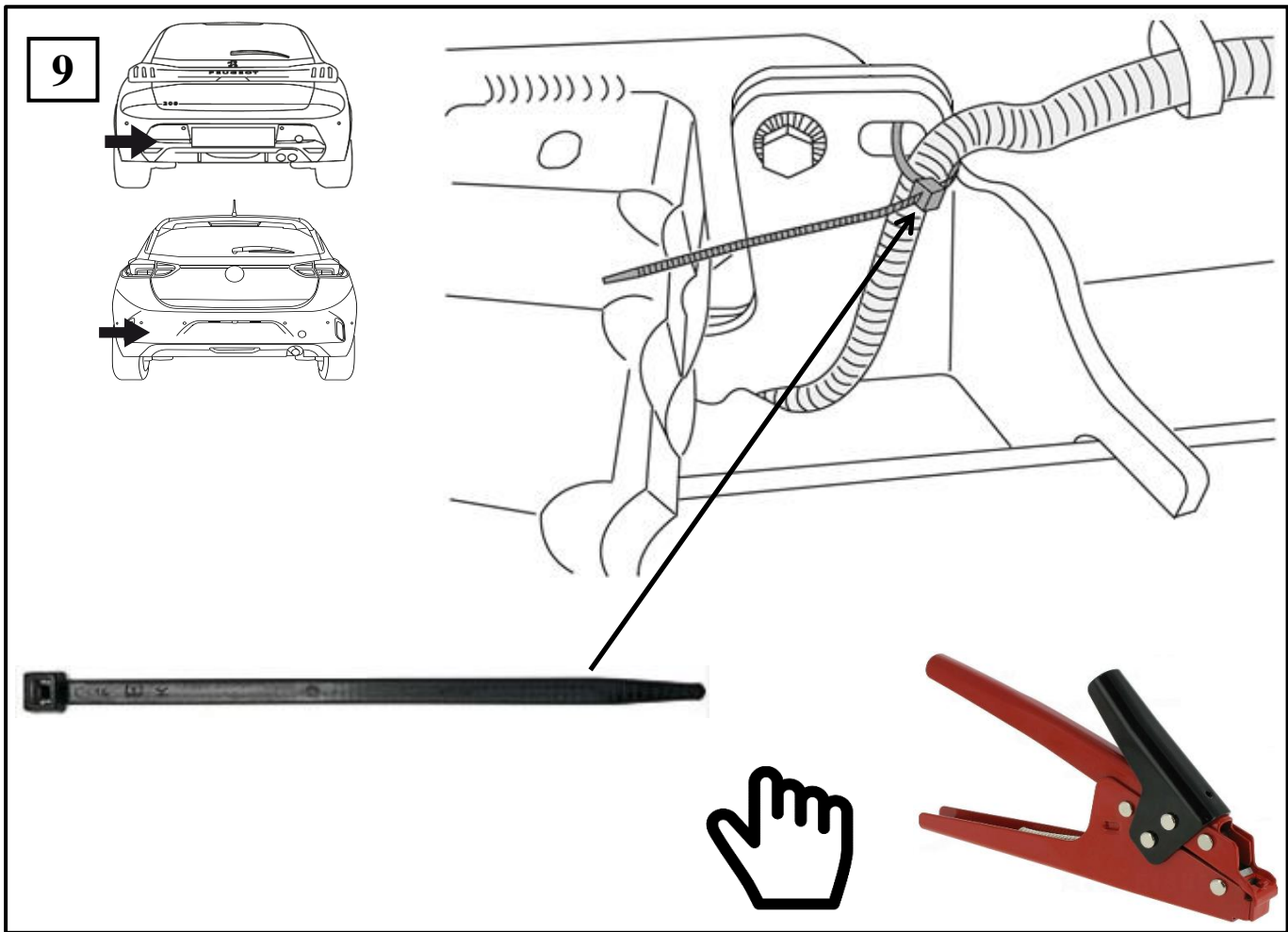

11

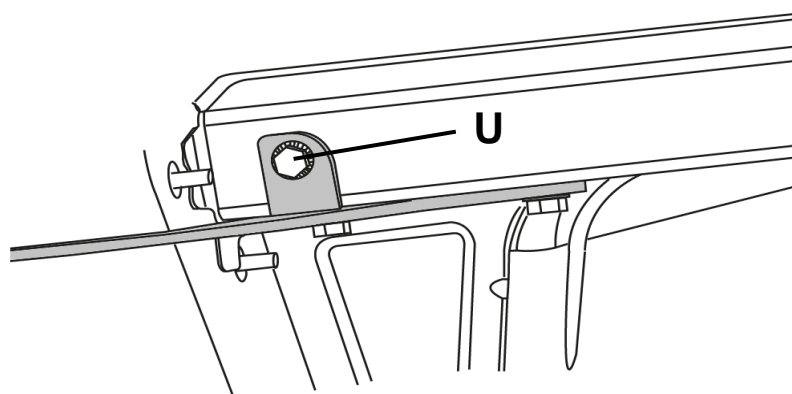
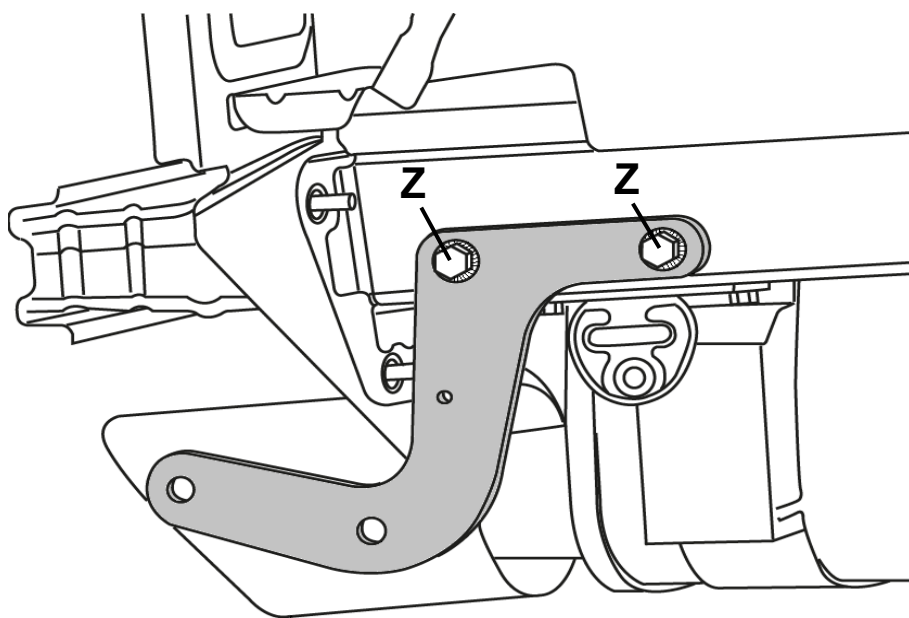
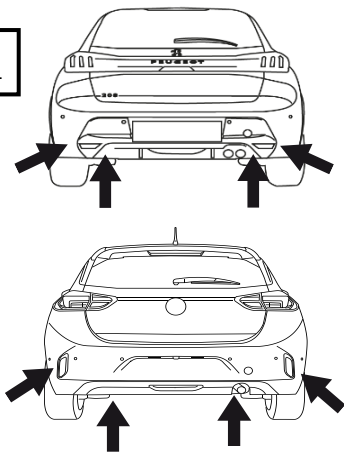

12

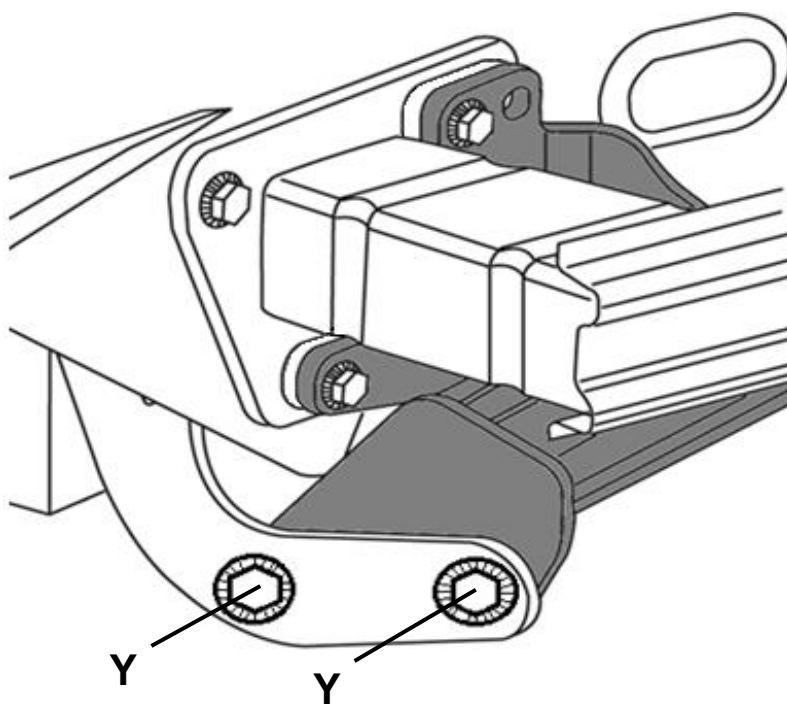
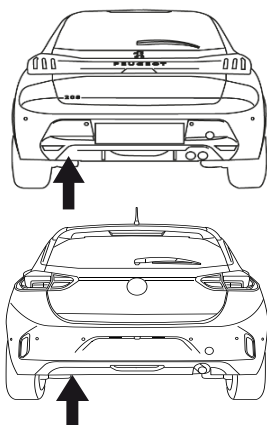

13

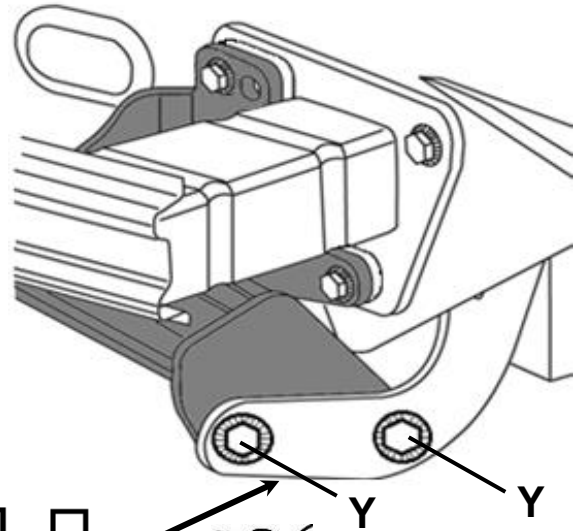
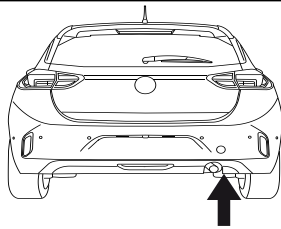
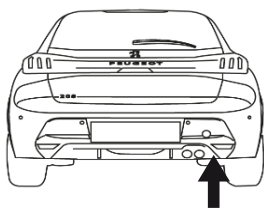

1 mm  
(x2)



2 mm  
(x2)

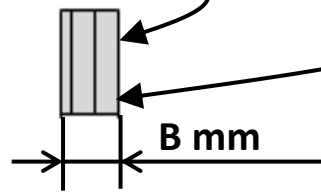
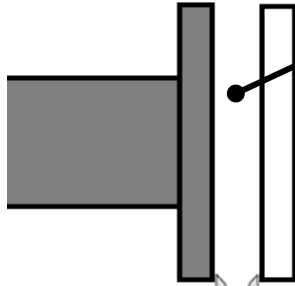

A mm = B mm

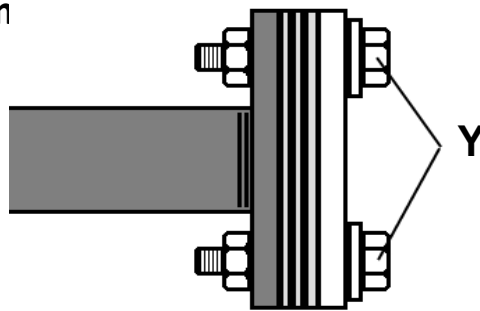
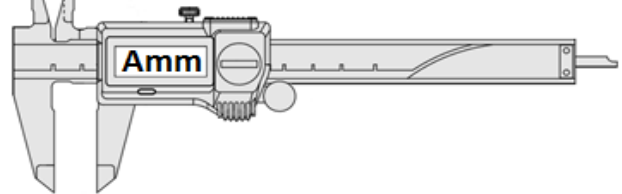

14



25 Nm

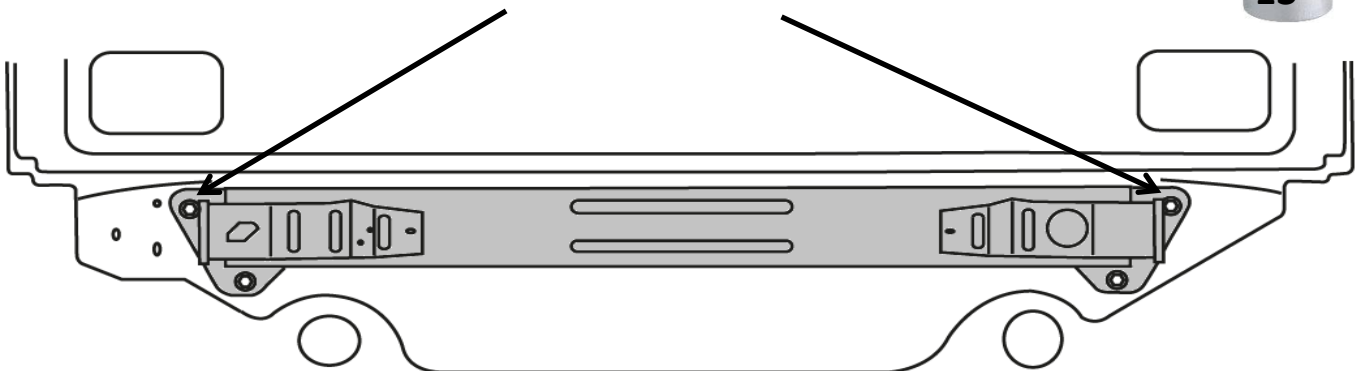



15

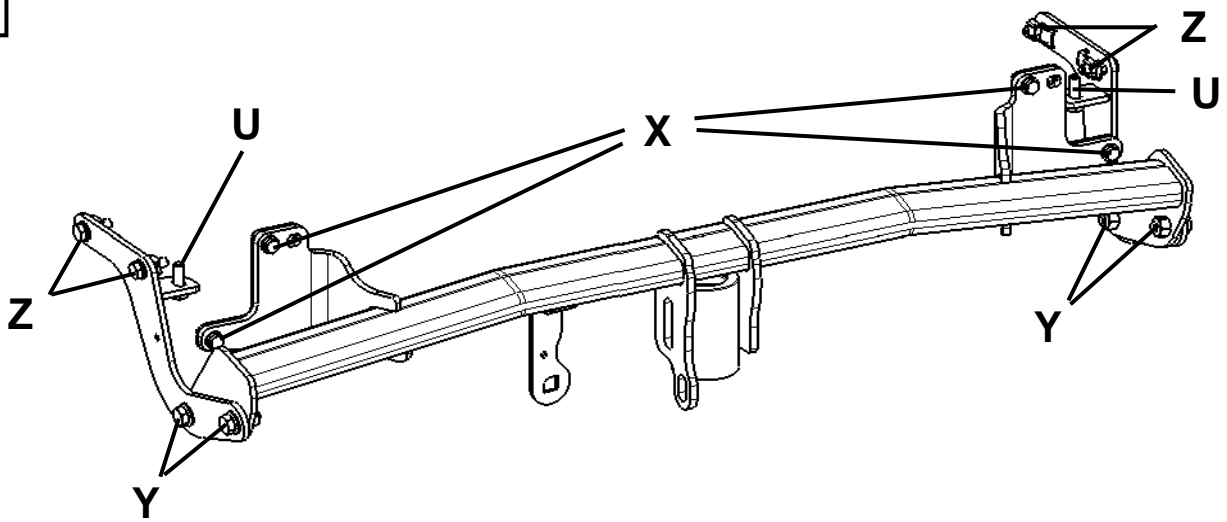

18



- 1) X (4) 25 Nm
- 2) U (2) 60 Nm
- 3) Z (4) 60 Nm
- 4) Y (4) 110 Nm

16

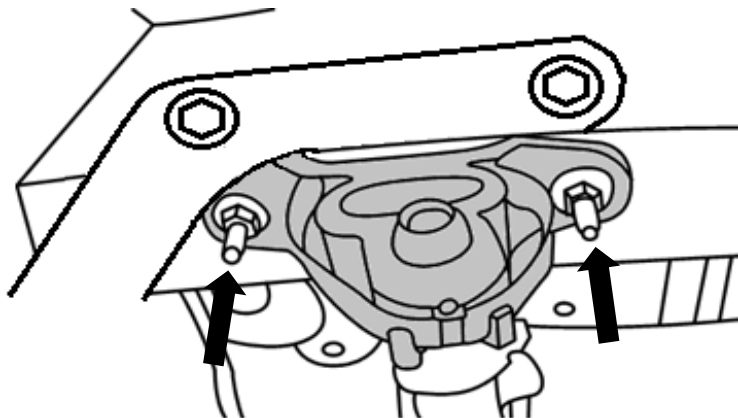

25 Nm

17

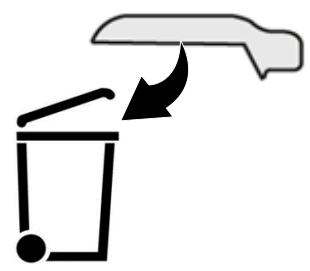
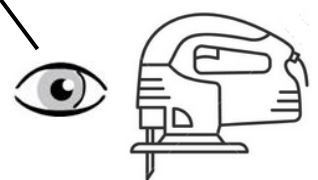
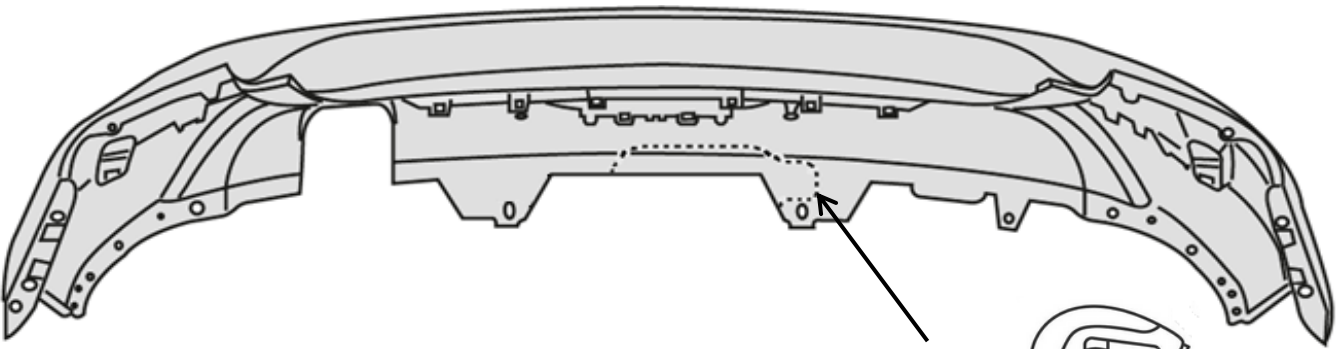
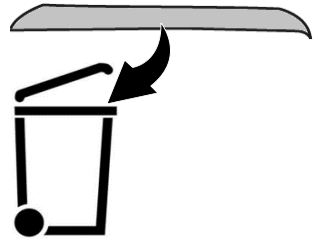
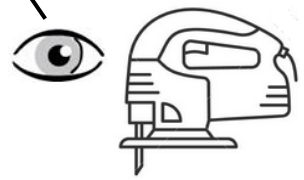
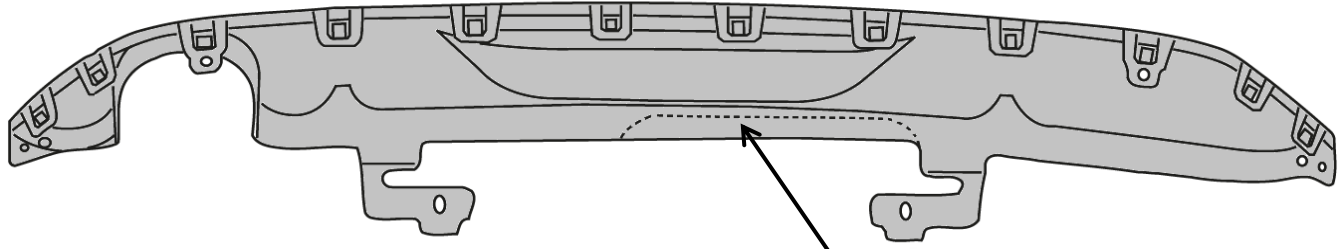

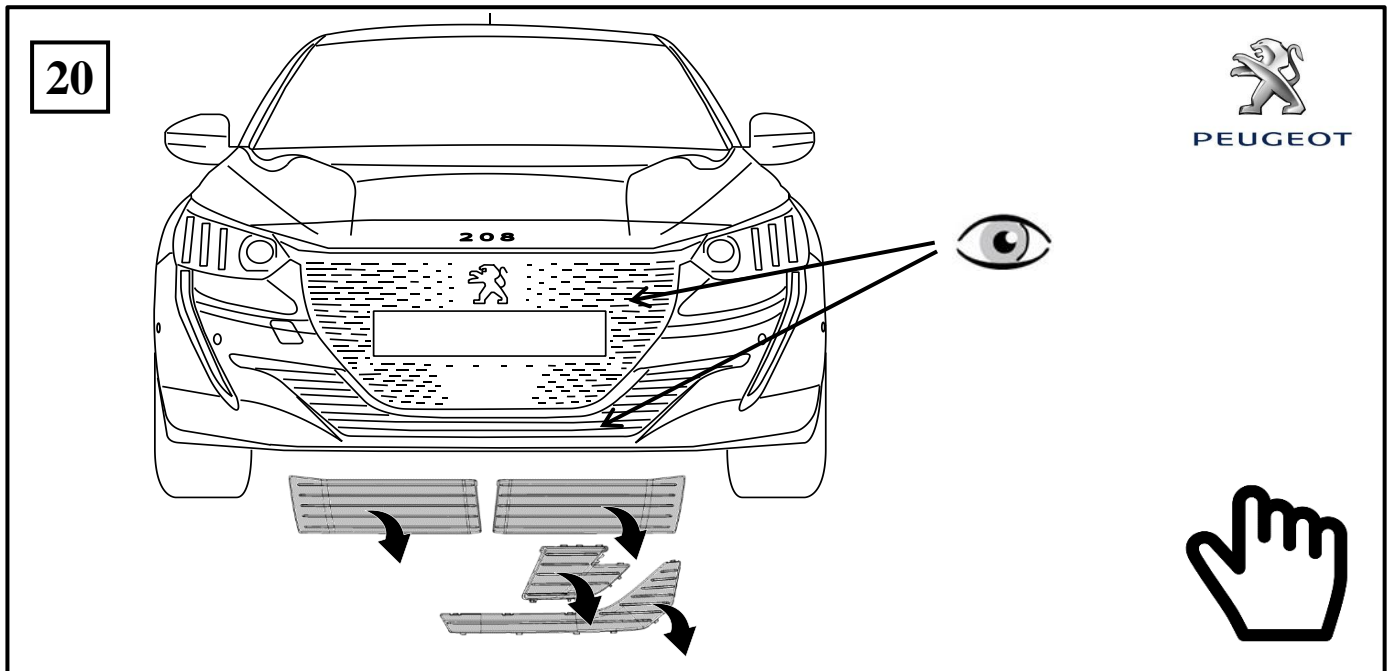
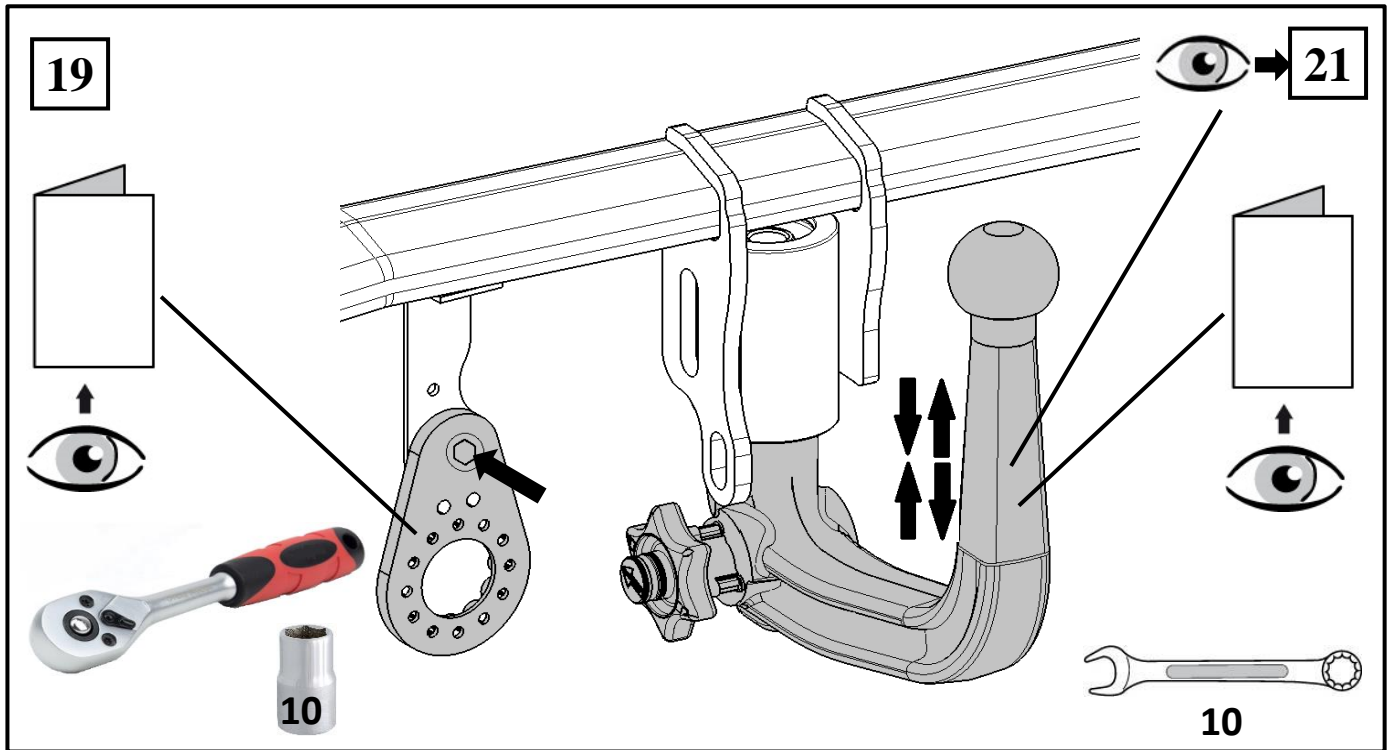
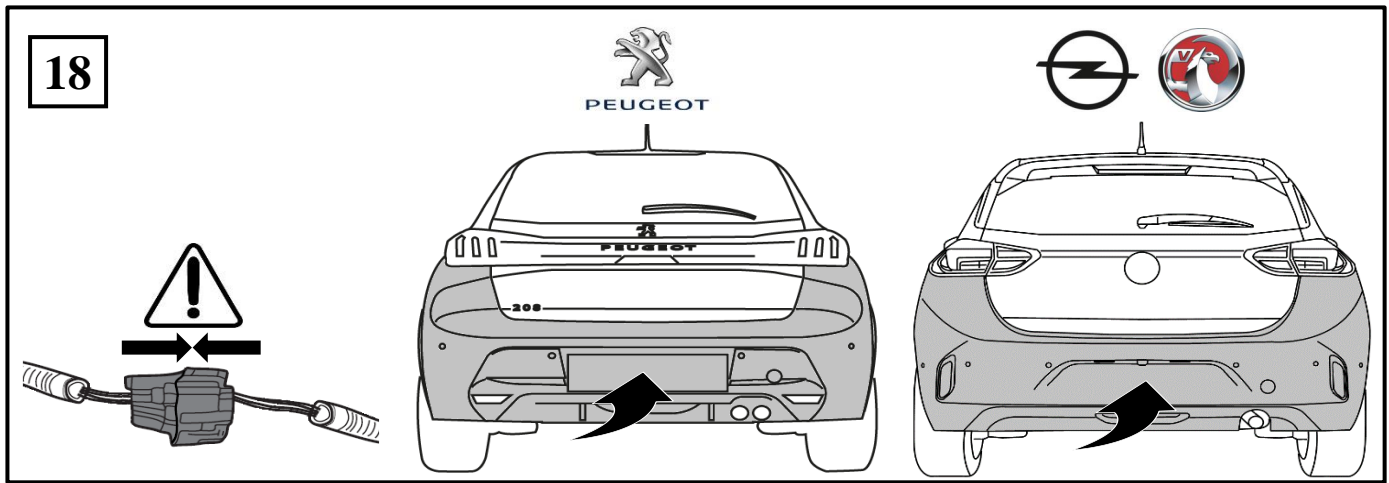

Date de création : 09/07/2019

Indice d'évolution : A

Date de modification : 26/09/2023

21

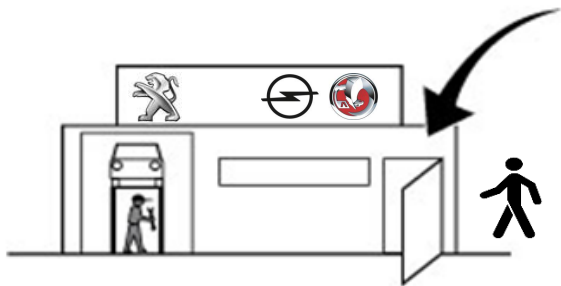

16 49 610 2 80



13106635

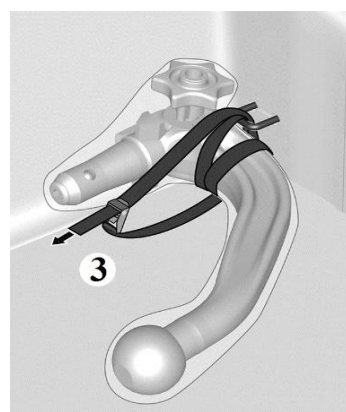
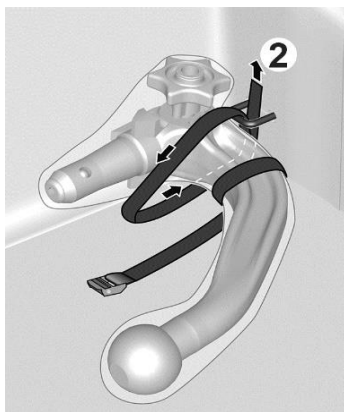
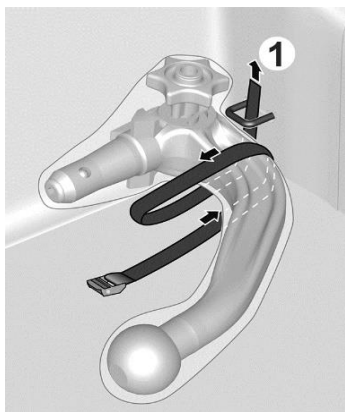
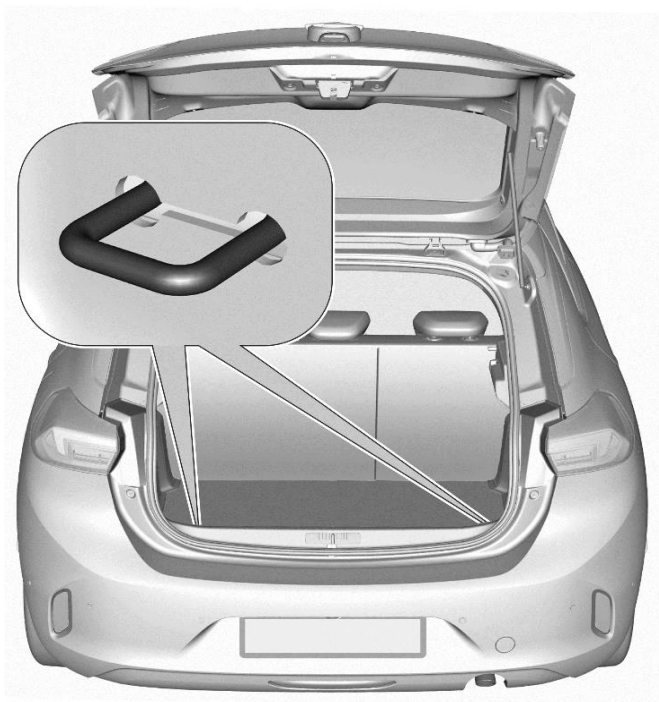

Dispositivo di traino tipo : **P 21 (208) / P2JO (Corsa)**  
Per autoveicolo : **Peugeot 208 / Opel Corsa**  
Tipo funzionale : **U\*\*\*\*\*\_\*\*\*\*\***

Classe e tipo di attacco : **A50-X**  
Omologazione : **e24\*R55\*01\*0486 (16 316 891 80 / 98 232 886 80)**  
Valore D : **7,00 kN**  
Carico verticale max. S : **55 kg**  
Larghezza rimorchiabile per Caravan e T.A.T.S. : 2,55m vedere CARTA di CIRCOLAZIONE VEICOLO (motrice) + 70cm = ...arrotondare ai 5cm superiore (vedi D.M.28/05/85)  
Massa rimorchiabile : vedi carta di circolazione dell'autoveicolo

**Per verificare l'idoneità del dispositivo di traino omologato a norma CEE R55, all'installazione sulla vettura su cui si intende procedere al montaggio, compilare la seguente formula (se necessario declassare la massa rimorchiabile) :**

$$D = \frac{T \times C}{T + C} \times 0,00981 < 6,81 \text{ kN}$$

dove : T = Massa Complessiva Max. della motrice (in kg)  
C = Massa Rimorchiabile Max. della motrice (in kg)

## DA COMPILARE PER IL COLLAUDO

**DICHIARAZIONE DI CORRETTO MONTAGGIO** : la sottoscritta Ditta dichiara di aver montato in maniera corretta ed in conformità alle prescrizioni sia del costruttore del veicolo che del costruttore del dispositivo stesso il seguente dispositivo di attacco meccanico :

tipo : .....  
Il dispositivo di attacco sopra indicato è stato installato su autoveicolo  
modello : .....  
targa : .....  
Data : .....

**TIMBRO e FIRMA**

**Si dichiara inoltre di aver informato l'utente del veicolo sull'USO e MANUTENZIONE del dispositivo stesso.**



ECE TYPE-APPROVAL CERTIFICATE



Communication concerning:

- Approval granted
  - Approval extended
  - Approval restricted
  - Approval withdrawn
  - Production definitively discontinued
- of a type of mechanical coupling device or component pursuant to Regulation No.55.

Approval No: E24\*55R01/10\*0486\*02

Reason for extension:

- See Test report 19-000666-CX-GBM-02 for full list

1. Trade name or mark of the device or component: **SIARR - Wexfolia**
2. Type of device or component: **SI261  
Non-standard coupling ball 50, detachable**
3. Manufacturer's name and address: **S.I.A.R.R. Sns  
rue du General de Gaulle  
F-76810 Luneray**
4. If applicable, name and address of the manufacturers representative: **N/A**
5. Alternative supplier's names or trade marks applied to the device or component: **N/A**
6. Name and address of the company or body taking responsibility for the conformity of production: **See item 3 above**
7. Submitted for approval on: **As before and 20.07.2023**
8. Technical service responsible for conducting approval tests: **TEV SÜD Auto Service GmbH,  
Westenstraße 199,  
D-80686 München,  
Germany**
9. Brief description: **Type: SI261**
- 9.1 Type and class of device or component: **Class: A50,X**

: Strike out what does not apply.

Approval No: E24\*55R01/10\*0486\*02

9.2 Characteristic values

9.2.1 Primary values:

D: 7 kN  
 Dc: -  
 S: 55 kg  
 U: -  
 V: -

Alternative values:

D: -  
 Dc: -  
 S: -  
 U: -  
 V: -

9.3 For Class A mechanical coupling devices or components, including towing brackets:

Vehicle manufacturer's maximum permissible vehicle mass: **1760 kg**  
 Distribution of maximum permissible vehicle mass between the axles: **Front: 935 kg / Back: 870 kg**

Vehicle manufacturer's maximum permissible towable trailer mass: **1200 kg**

Vehicle manufacturer's maximum permissible static mass on coupling ball: **55 kg**

Maximum mass of vehicle, with bodywork, in running order, including coolant, oils, fuel, tools and spare wheel (if supplied) but not including driver: **1303 kg**

Loading condition under which the tow ball height of a mechanical coupling device fitted to category M1 vehicles is to be measured – see paragraph 2 of annex 7, appendix 1:

9.4 For class B coupling heads, is the coupling head intended to be fitted to an unbraked O1 trailer: **yes/no\*** **N/A**

10. Instructions for the attachment of the coupling device or component type to the vehicle and photographs or drawings of the mounting points given by the manufacturer: **See manufacturer's documentation**

11. Information on the fitting of any special reinforcing brackets or plates or spacing components necessary for the attachment of the coupling device or component: **See manufacturer's documentation**



Approval No: E24-5580/10-0486-02

- 12. Additional information where the use of coupling device or component is restricted to special types of vehicles  
- see annex 5, paragraph 3.4: *See manufacturer's documentation*
- 13. For Class K hook type couplings, details of the drawbar eyes suitable for use with the particular hook type: *N/A*
- 14. Date of test report: *As before and 19.07.2023*
- 15. Number of test report: *19-00066-CX-GBM Up to -02*
- 16. Approval mark position: *See manufacturer's drawings*
- 17. Reason(s) for extension of approval: *See top of page 1 of certificate for details*
- 18. Approval ~~granted~~ extended: *Extended*
- 19. Place: *Dublin*
- 20. Date: *28<sup>th</sup> July, 2023*
- 21. Signature: 
- 22. The list of documents deposited with the Administration Service which has granted approval is annexed to this communication and may be obtained on request.

